

Plan

14980010038 Tip-up seat

PRODUCT



PRODUCT ATTRIBUTES

tip-up, wall mounted

SURFACE

polished chrome/light grey (RAL 7035)

DRAWING

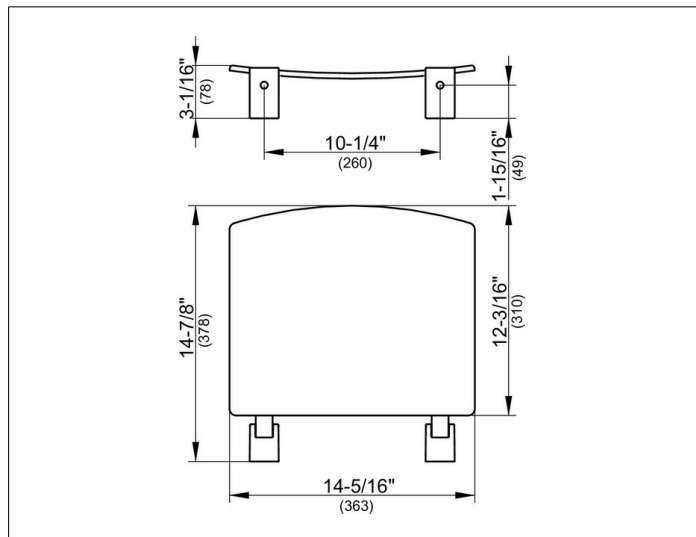

SPECIFICATIONS

KEUCO PLAN Tip-up seat
14980010038

Light grey (RAL 7035) Fold-up seat
made from Polypropylene
in esthetic, practical Design,
for wall mounting
for secure seating in the shower
Wall support and seat support
as Design Feature high shine chrome-plated
anti-static,
easy Cleaning
upward foldable seat
load capacity up to 110 kg
Width 363 mm,
seat area 310 mm
Distance between boreholes 260 mm,
Extendable 378 mm
The seat will be mounted on 2 discrete brackets
and is TUEV-GS tested
The Mounting material is to be ordered separately!

It is essential for installation to order the correct screws/bolts depending on type of wall,
please see below

1 x Mounting-Set 3 (Catalogue-no. 34992000100) or
1 x Mounting-Set 6 (Catalogue-no. 34992000200) or
1 x Mounting-Set 9 (Catalogue-no. 34995000200) or
1 x Mounting-Set 11 (Catalogue-no. 34997000100)

Warranty: KEUCO products are covered by a 5-year manufacturer's warranty, in effect from the date of purchase. During this time, proven product defects will be remedied free of charge. Warranty claims must be filed in writing, including a detailed description of the defect immediately after a defect has occurred. For a copy of our detailed product warranty policy, please contact us at office-usa@keuco.com.

Installation: KEUCO products must be installed by a qualified professional in accordance with the respective installation guidelines and any applicable federal / local building codes and regulations.