

**Collection Moll**

**12718010000 Towel holder**

**PRODUCT**



**DRAWING**

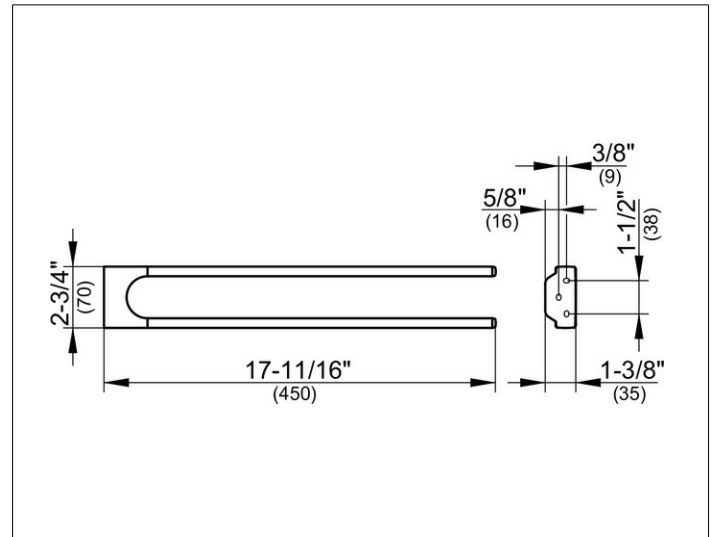

**PRODUCT ATTRIBUTES**

fixed

**SURFACE**

polished chrome

**DIMENSION**

17,72 "

**SPECIFICATIONS**

KEUCO COLLECTION MOLL towel holder 12718010000

Chrome-plated towel holder in an esthetic design with slightly rounded edges

Two parallel arranged fixed arms

Anti-static, easy to clean,

Projection: 17-11/16"

The towel holder is fitted with two hidden fixing points

incl. corrosion-free mounting material

**Warranty:** KEUCO products are covered by a 5-year manufacturer's warranty, in effect from the date of purchase. During this time, proven product defects will be remedied free of charge. Warranty claims must be filed in writing, including a detailed description of the defect immediately after a defect has occurred. For a copy of our detailed product warranty policy, please contact us at [office-usa@keuco.com](mailto:office-usa@keuco.com).

**Installation:** KEUCO products must be installed by a qualified professional in accordance with the respective installation guidelines and any applicable federal / local building codes and regulations.