

**Elegance NEW**

**11657010001 Shower basket for corner installation**

**PRODUCT**



**PRODUCT ATTRIBUTES**

two parts: metal basket and detachable  
synthetic insert, soap resistant, shatterproof, UV-protected

**SURFACE**

chrome-plated/anthracite

**DRAWING**

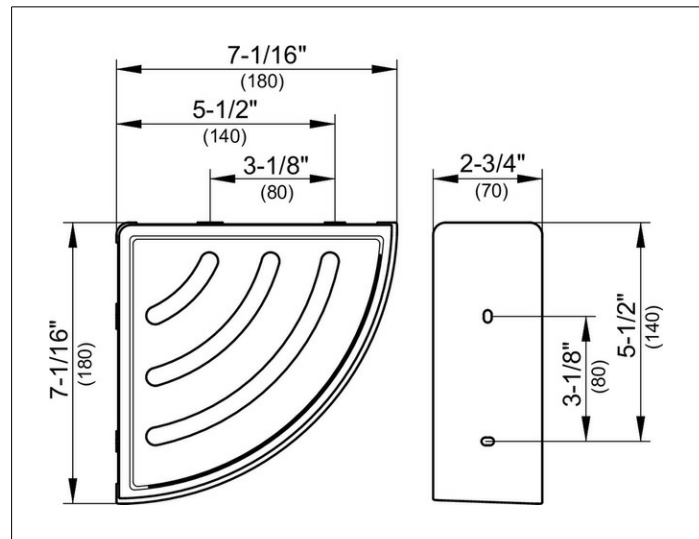

**SPECIFICATIONS**

KEUCO ELEGANCE sponge basket for corner installation 11657010001

Two parts: metal basket (chrome-plated) and detachable (white)

Synthetic insert, soap resistant, unbreakable, uv-protected

chrome-plated sponge basket for corner installation in an elegant design,  
easy to clean,

total depth 7-1/16", width 7-1/16", height 2-3/4", projection 7-1/16"

incl. corrosion-free mounting material

**Warranty:** KEUCO products are covered by a 5-year manufacturer's warranty, in effect from the date of purchase. During this time, proven product defects will be remedied free of charge. Warranty claims must be filed in writing, including a detailed description of the defect immediately after a defect has occurred. For a copy of our detailed product warranty policy, please contact us at [office-usa@keuco.com](mailto:office-usa@keuco.com).

**Installation:** KEUCO products must be installed by a qualified professional in accordance with the respective installation guidelines and any applicable federal / local building codes and regulations.