

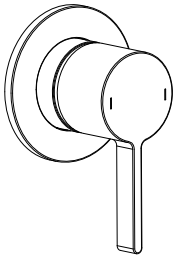

BALANCE. STYLE. QUALITY.



120102 (01-06)

Concealed single lever shower valve

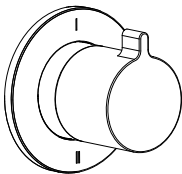

120104 (01-06)

2-way concealed diverter (Without closing function)

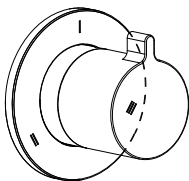

120107 (01-06)

3-way concealed diverter (Without closing function)

CONTENT

120102	(See page 02-05)
120104	(See page 06-07)
120107	(See page 08-09)

Vertical installation - Standard

120102+120104	(See page 10)
120102+120107	(See page 11)

Horizontal installation

120102+120104	(See page 12-13)
120102+120107	(See page 14-15)

OPERATING SPECIFICATIONS



Hot Water Supply Temperature:

45° C - 60° C

Recommended Operating Pressure:

1Bar - 5Bar

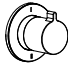
FLOW RATE

Code	Photo	1 Bar (L/MIN)	2 Bar (L/MIN)	3 Bar (L/MIN)	4 Bar (L/MIN)	5 Bar (L/MIN)
120102		12	17.8	22	25.5	28.6
120104 -(Tested with 120102)		10.9	15.9	19.6	22.7	25.4
120107 -(Tested with 120102)		10.5	15.2	18.7	21.8	24.4

Installation Instructions

- Prior to installation, inspect the product for transport damages. After it has been installed, no transport or surface damage will be honoured.
- The pipes and the fixture must be installed, flushed and tested as per the applicable standards.
- The plumbing codes applicable in the respective countries must be observed

120102 (01-06)

Concealed single lever shower valve

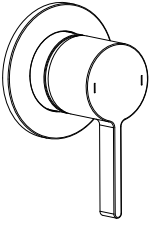

Demension Drawing

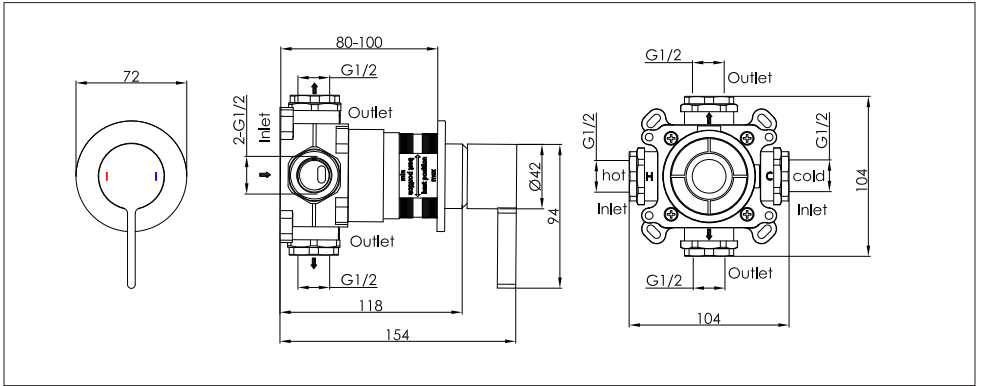

Explosive Drawing

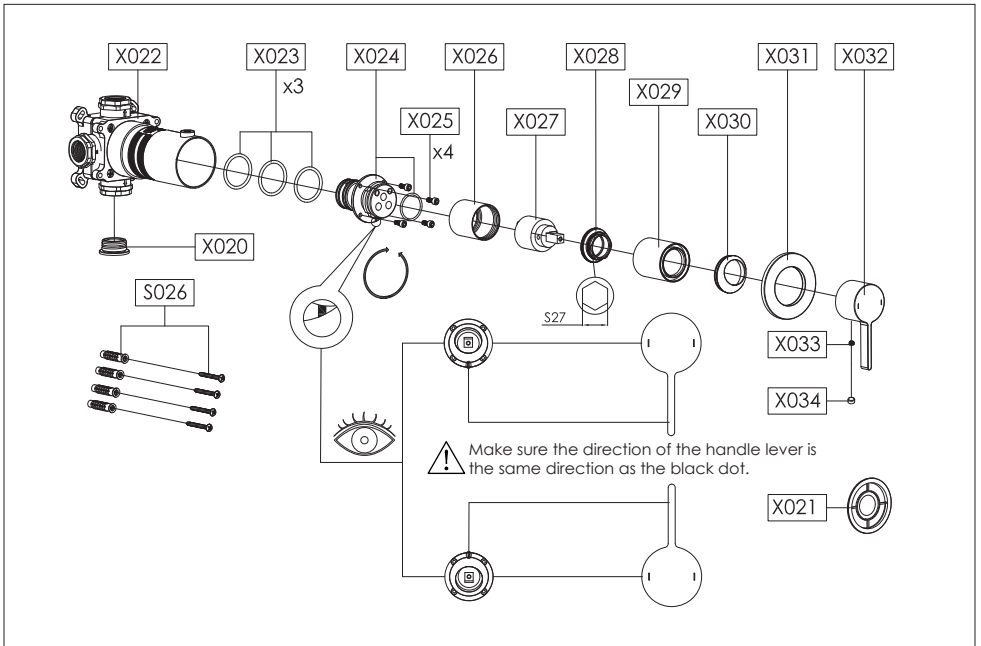

Installation Steps

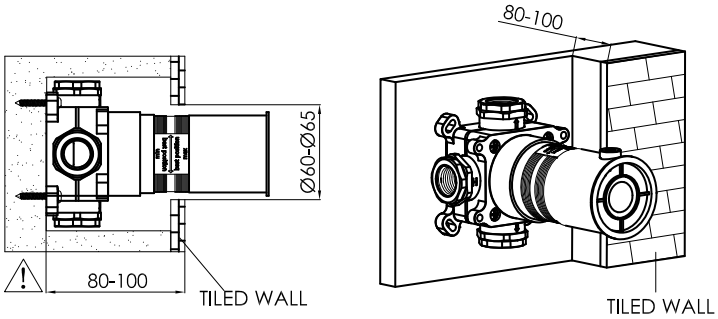
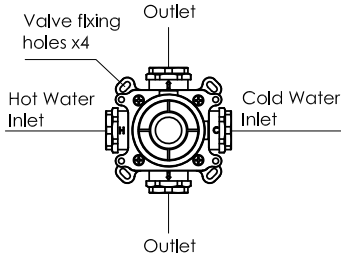

1

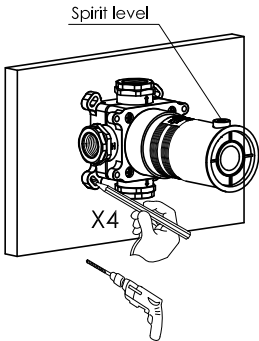

2

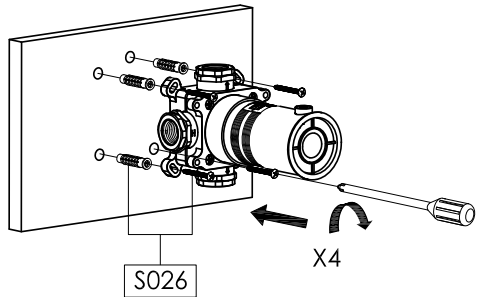

3

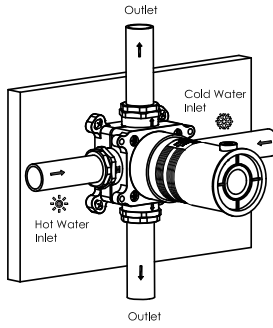

4

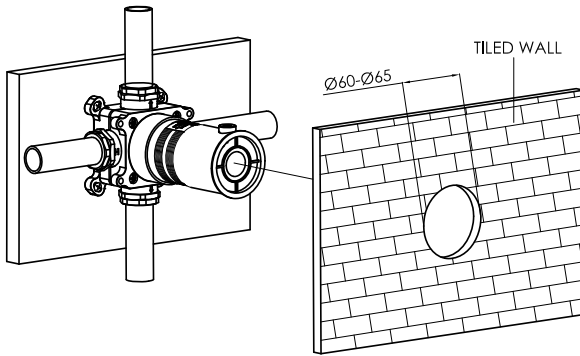

5

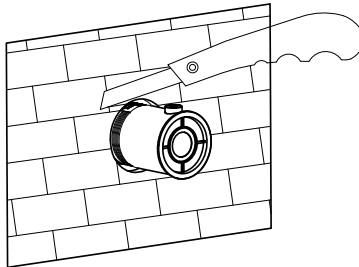

6

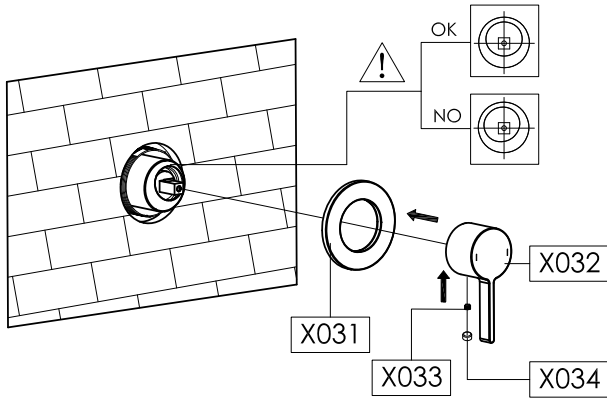

7

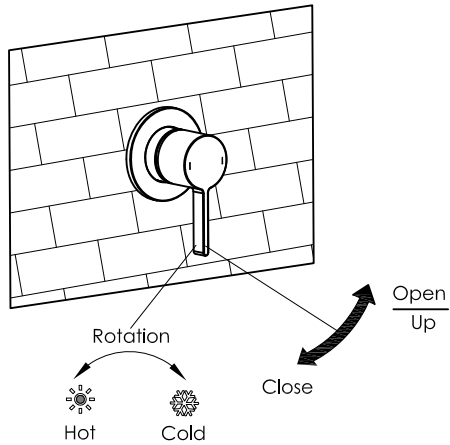

120104 (01-06)

2-way concealed diverter
(Without closing function)

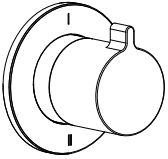

Demension Drawing

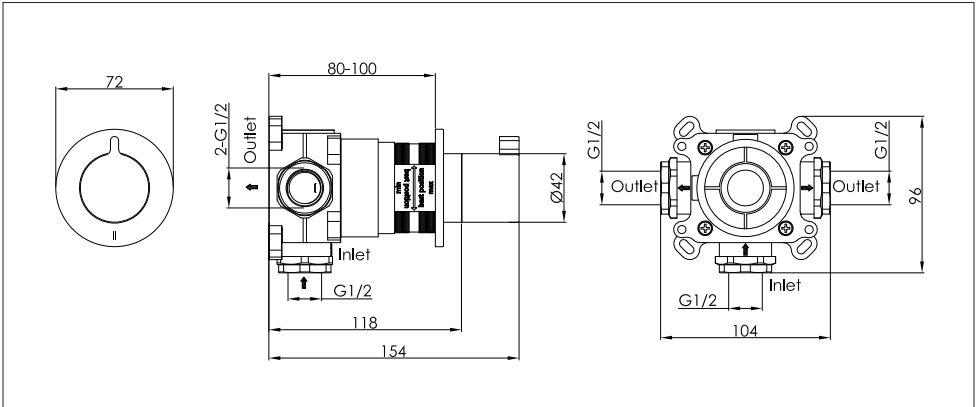

Explosive Drawing

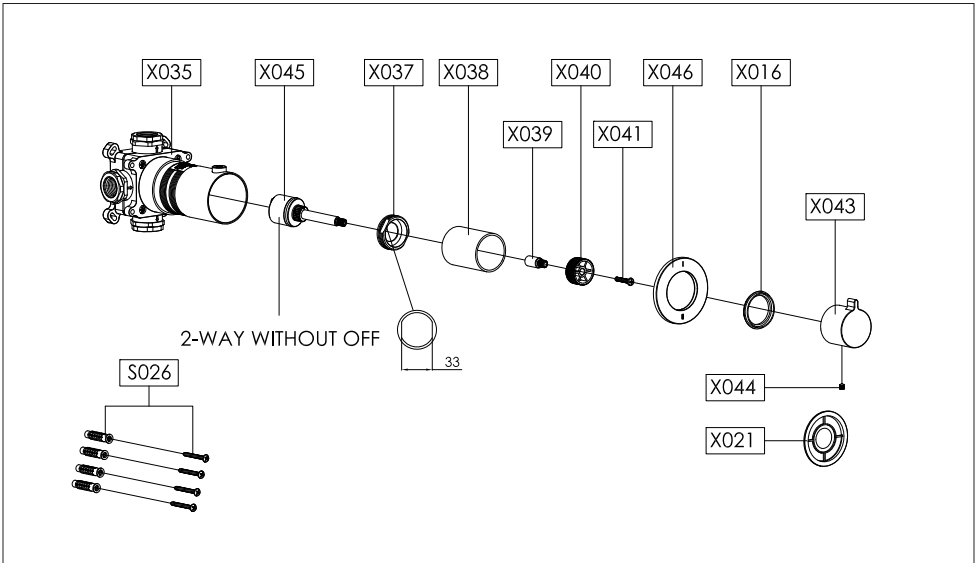

Installation Steps

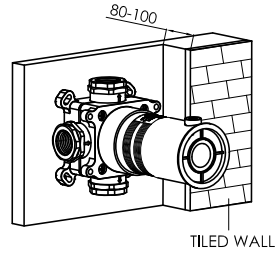
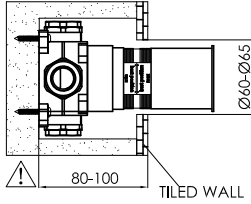
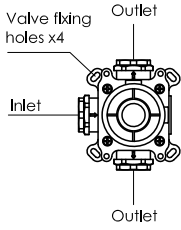

1

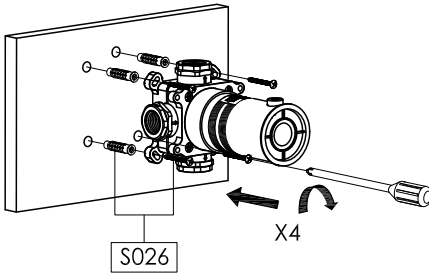

2

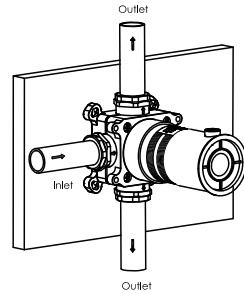

3

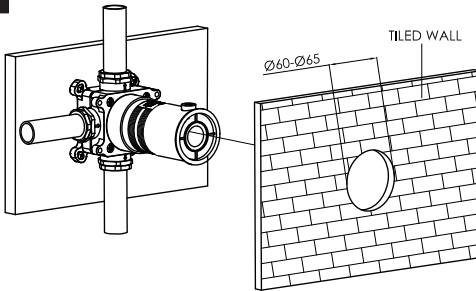

4

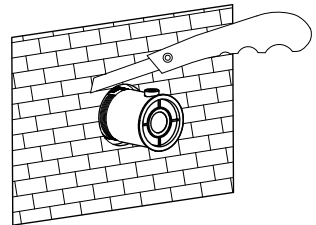

5

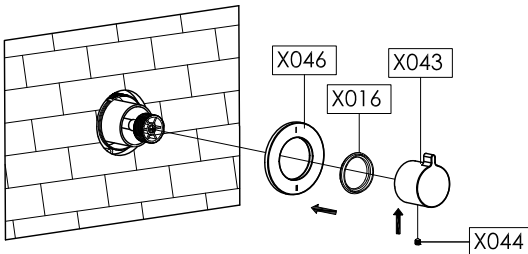

6

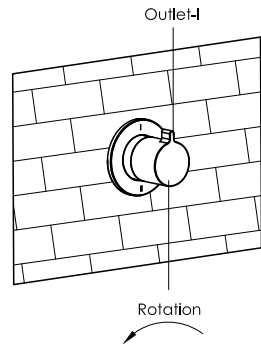

120107 (01-06)

3-way concealed diverter
(Without closing function)

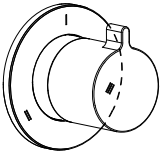

Dimension Drawing

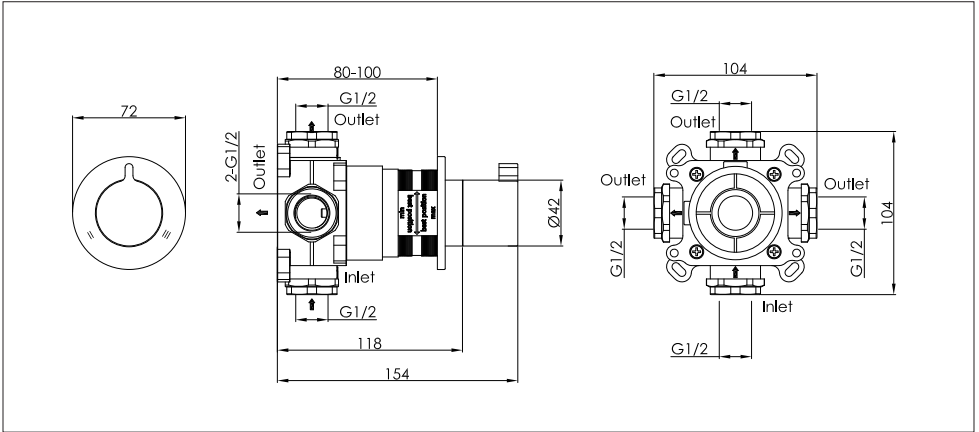

Explosive Drawing

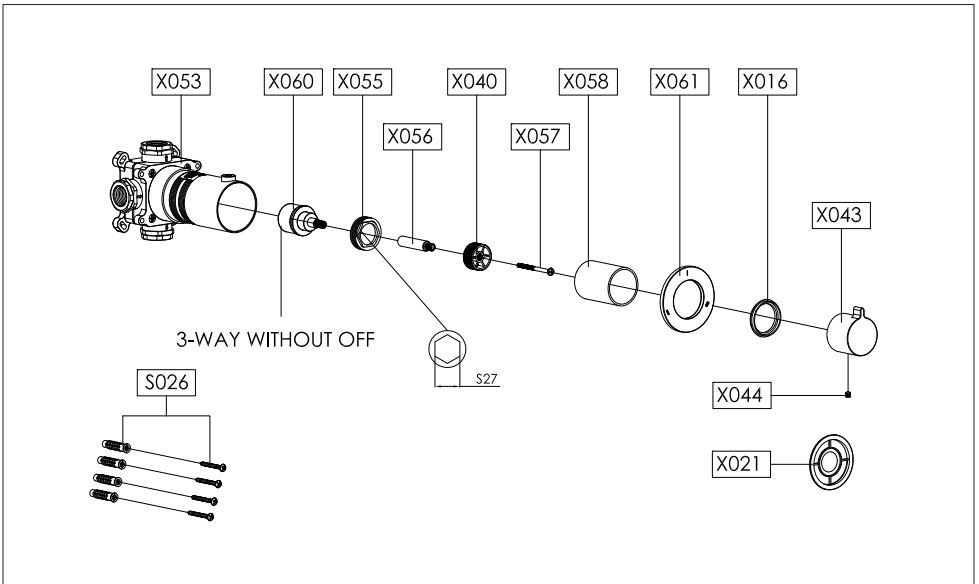

Installation Steps

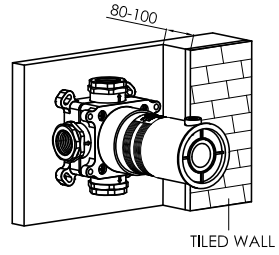
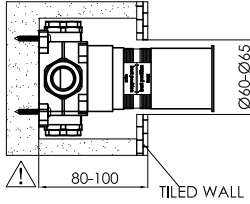
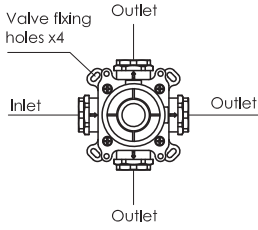

1

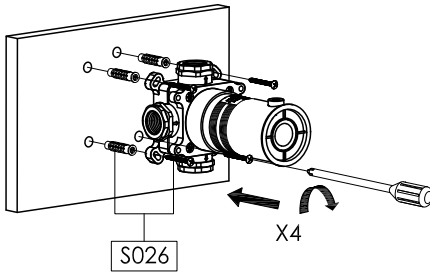

2

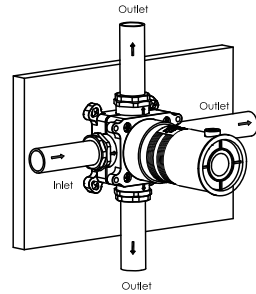

3

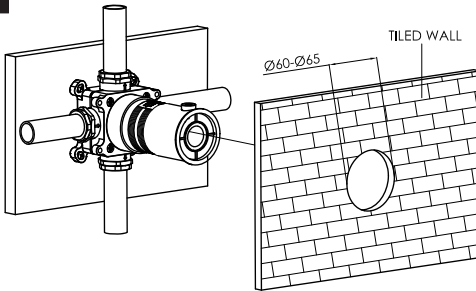

4

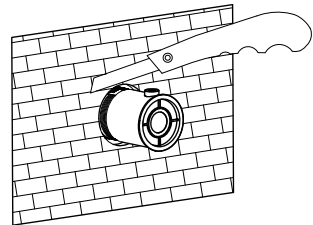

5

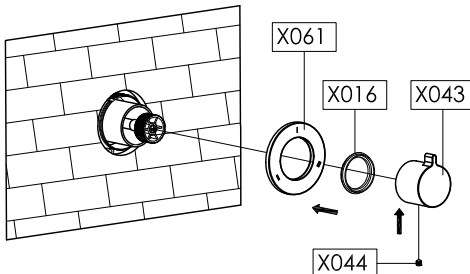

6

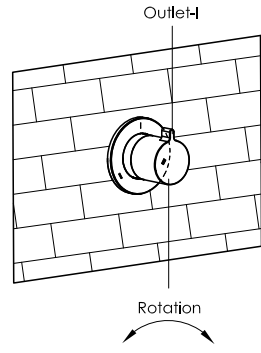

Vertical mounting instructions

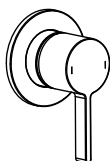
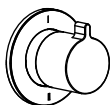

120102 (01-06)

Concealed single lever shower valve

120104 (01-06)

2-way concealed diverter
(Without closing function)

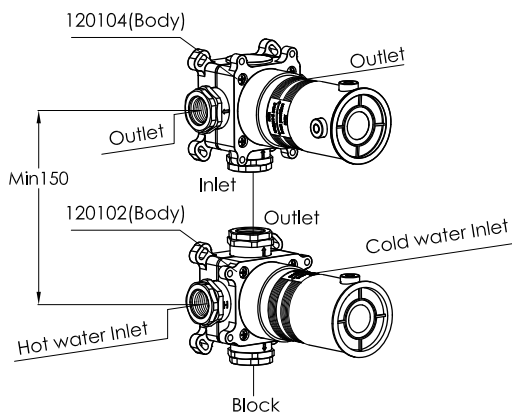
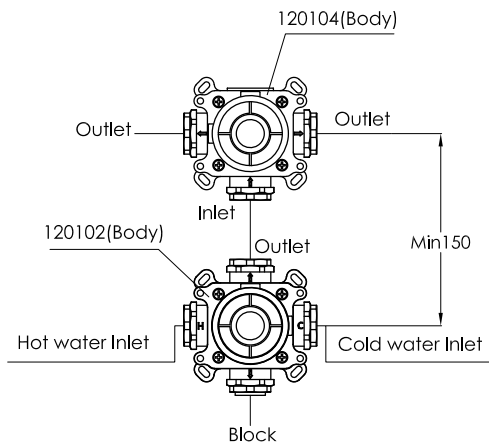

Vertical mounting instructions

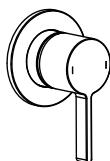
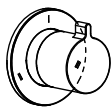

120102 (01-06)

Concealed single lever shower valve

120107 (01-06)

3-way concealed diverter
(Without closing function)

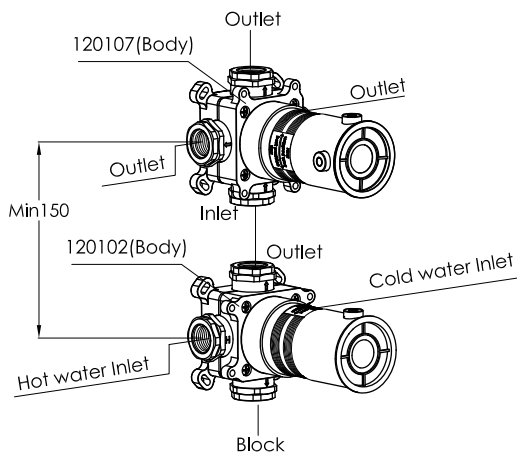
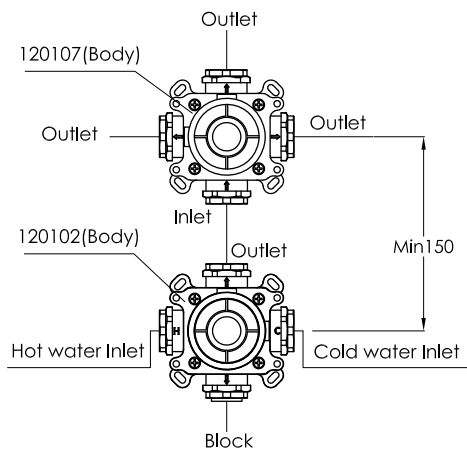

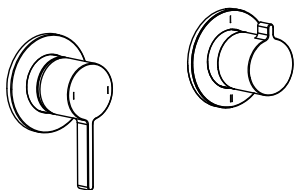

1

⚠ If installing horizontally, it is recommended to adjust the cartridge position before installing it in the wall!

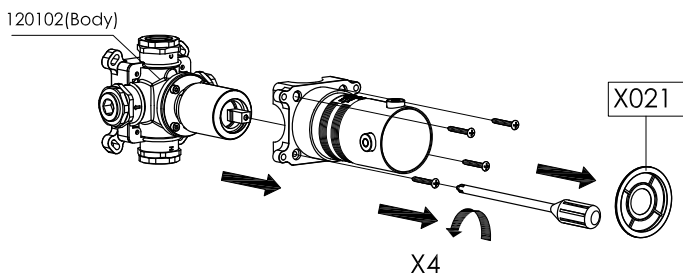

2

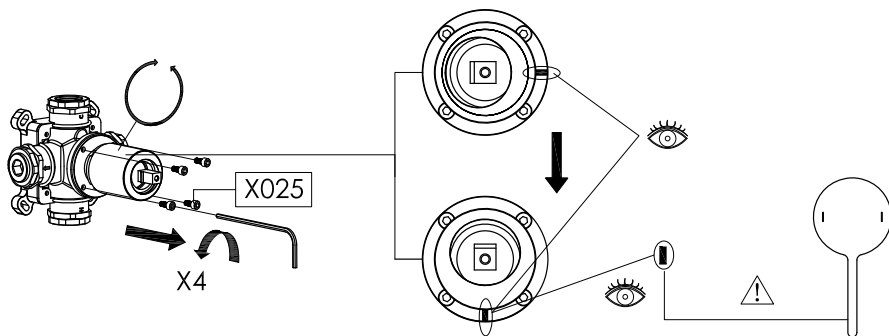

⚠ Make sure the direction of the handle lever is the same direction as the black dot.

3

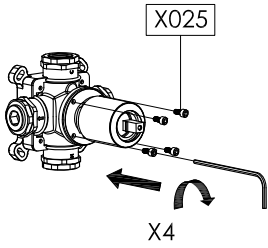

4

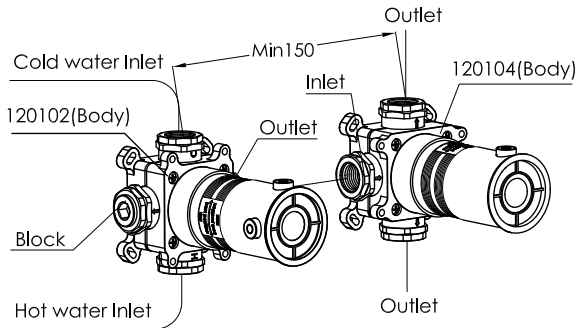
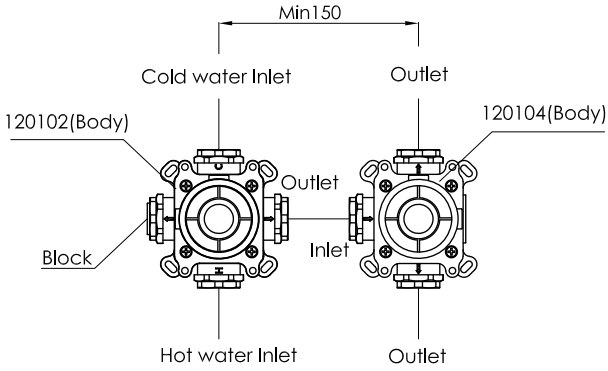
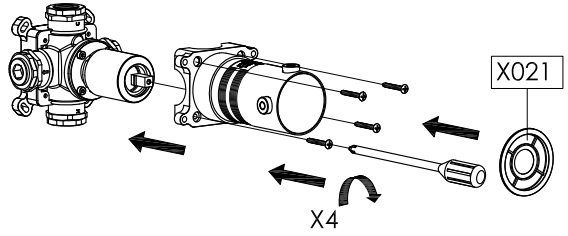

Horizontal mounting instructions

120102 (01-06)

120107 (01-06)

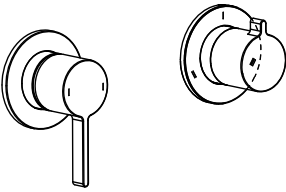

1

⚠ If installing horizontally, it is recommended to adjust the cartridge position before installing it in the wall!

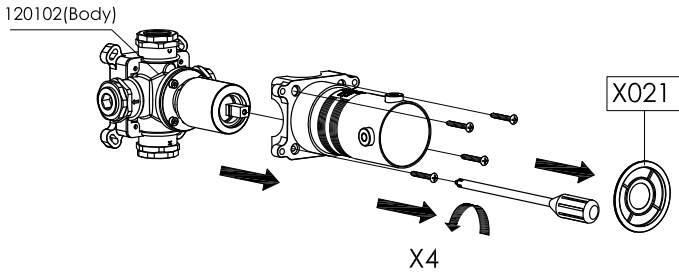

2

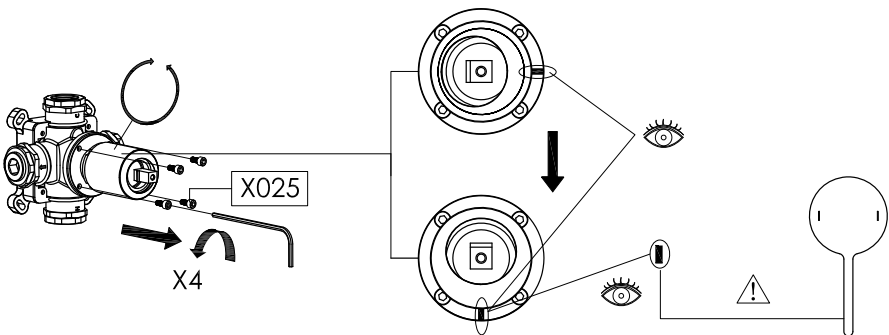

⚠ Make sure the direction of the handle lever is the same direction as the black dot.

3

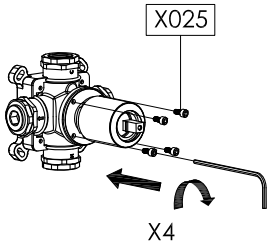

4

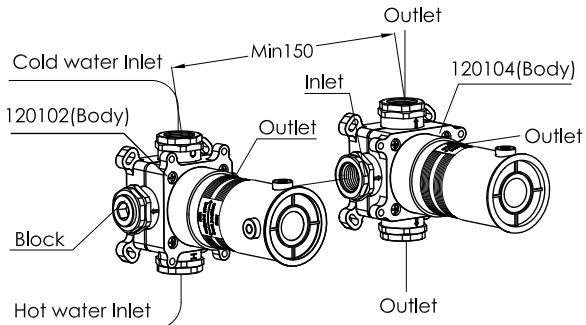
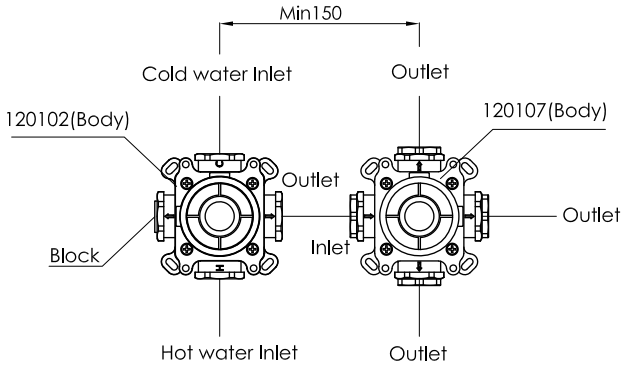
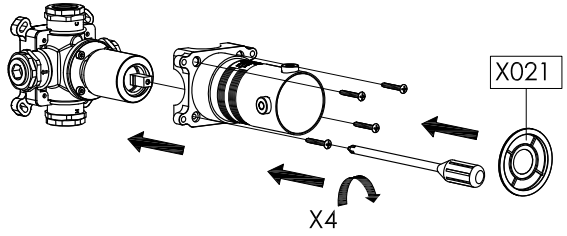

Cartridge replacement

120102 (01-06)

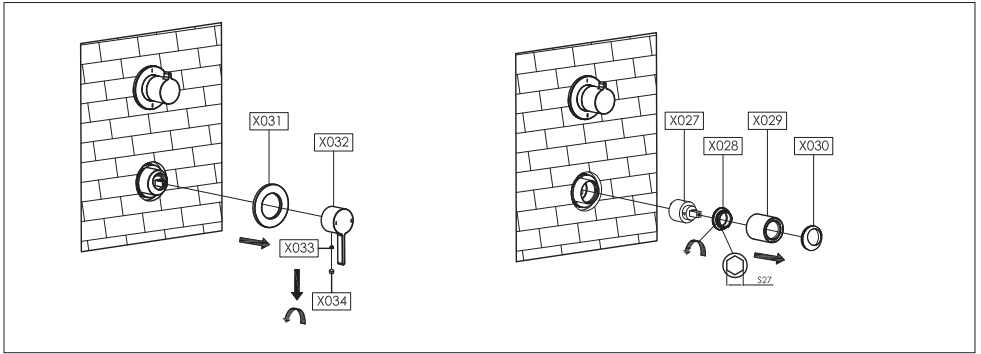

120104 (01-06)

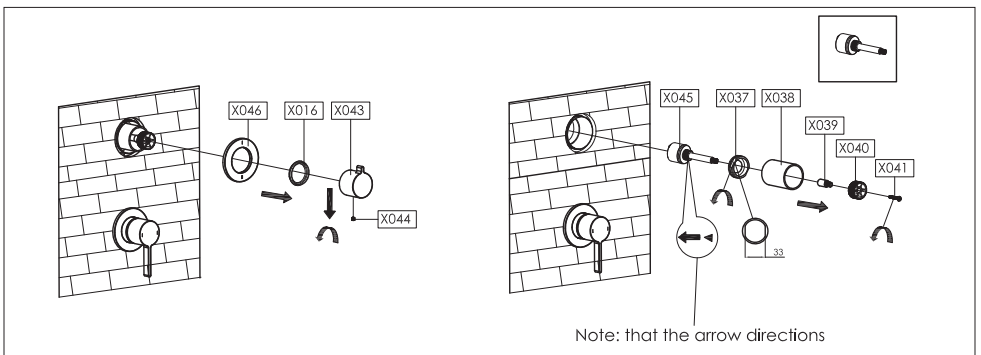

120107 (01-06)

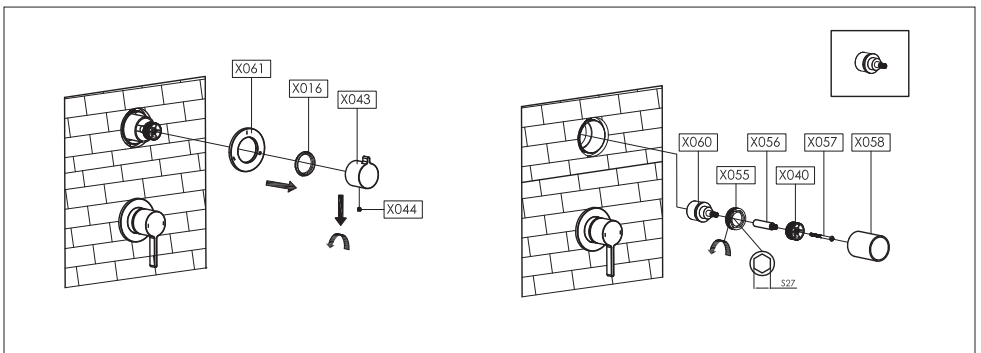

Cartridge replacement

120104 (01-06)

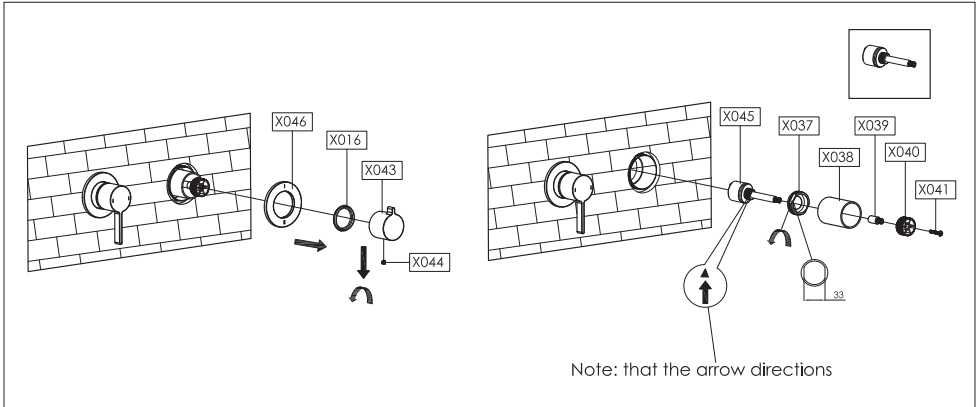

120107 (01-06)

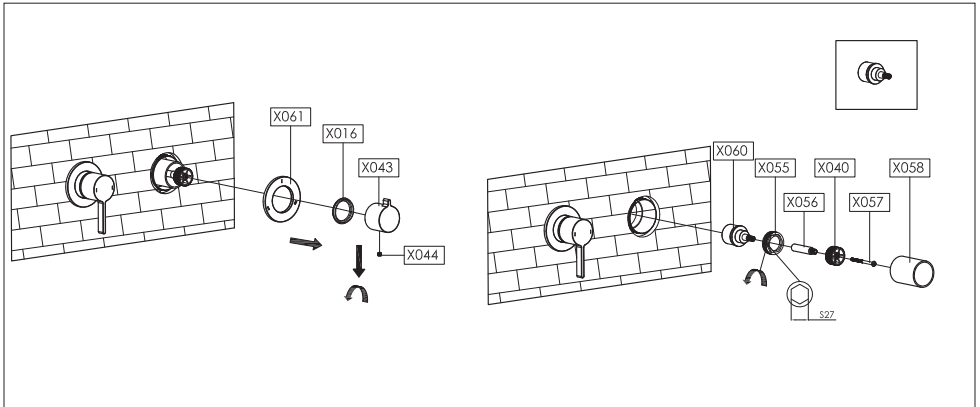

MAINTENANCE

CARE OF THE MIXER

Our products are finished to the highest standard and due care needs to be taken to ensure their looks are retained.

We recommend cleaning all products with a soft damp cloth **ONLY** and advise strongly against the use of **ALL** cleaning products i.e. powders and liquids.

If the above instructions are not followed this will invalidate your guarantee in the event of a problem occurring.

