

**Plan**

**14955019000 Soap holder**

**PRODUCT**



**PRODUCT ATTRIBUTES**

complete with crystal soap dish

**SURFACE**

polished chrome

**DRAWING**

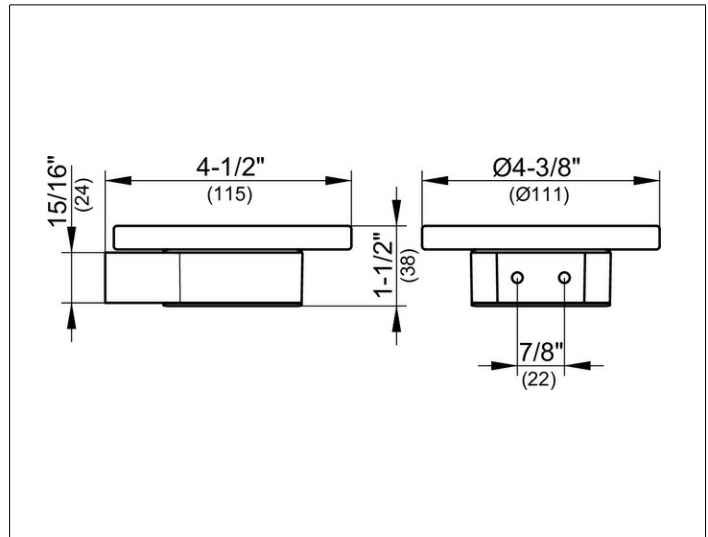

**SPECIFICATIONS**

KEUCO PLAN soap holder 14955019000

Chrome-plated soap holder in a stylish yet functional design

Complete with a removable crystal soap dish, (diameter 4-6/16"),

Easy to clean,

Width 4-3/8", height 1-1/2", projection 4-1/2"

The soap holder is fitted with 2 hidden fixing points

incl. corrosion-free mounting material

**Warranty:** KEUCO products are covered by a 5-year manufacturer's warranty, in effect from the date of purchase. During this time, proven product defects will be remedied free of charge. Warranty claims must be filed in writing, including a detailed description of the defect immediately after a defect has occurred. For a copy of our detailed product warranty policy, please contact us at [office-usa@keuco.com](mailto:office-usa@keuco.com).

**Installation:** KEUCO products must be installed by a qualified professional in accordance with the respective installation guidelines and any applicable federal / local building codes and regulations.