

**120101 (01-06)**

Concealed thermostatic valve

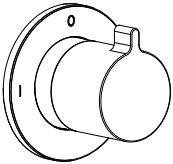

**120105 (01-06)**

Concealed stop valve

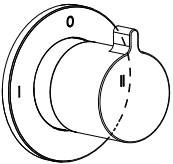

**120103 (01-06)**

2-way concealed diverter (including closing function)

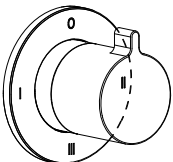

**120106 (01-06)**

3-way concealed diverter (including closing function)

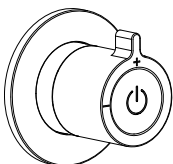

**120108 (01-06)**

Push-button concealed stop valve with flow adjustment

# CONTENT

120101 .....	(See page 02-05)
120105 .....	(See page 06-07)
120103 .....	(See page 08-09)
120106 .....	(See page 10-11)
120108 .....	(See page 12-13)

## Vertical installation - Standard

120101+120103 .....	(See page 14)
120101+120106 .....	
120101+120105+120105 .....	(See page 15)
120101+120105+120103 .....	
120101+120108+120108 .....	(See page 18)

## Horizontal installation





120101+120103 .....	(See page 16)
120101+120106 .....	
120101+120105+120105 .....	(See page 17)
120101+120105+120103 .....	
120101+120108+120108 .....	(See page 19)

# OPERATING SPECIFICATIONS

Hot Water Supply Temperature:  
Maximum: 60-65° C

Recommended Operating Pressure:  
1Bar - 5Bar

## FLOW RATE

Code	Photo	1 Bar (L/MIN)	2 Bar (L/MIN)	3 Bar (L/MIN)	4 Bar (L/MIN)	5 Bar (L/MIN)
120101		17	24.8	30	34.7	39
120105 -(Tested with 120101)		13.7	20.1	24.8	28.7	32.1
120103 -(Tested with 120101)		12.5	18.4	22.5	26.3	29.4
120106 -(Tested with 120101)		12.5	18.4	22.5	26.3	29.4
120108 -(Tested with 120101)		MAX:12 MIN:4.6	MAX:18 MIN:6.5	MAX:22.4 MIN:6.8	MAX:26 MIN:7.3	MAX:29 MIN:7.3

## Installation Instructions

- Prior to installation, inspect the product for transport damages. After it has been installed, no transport or surface damage will be honoured.
- The pipes and the fixture must be installed, flushed and tested as per the applicable standards.
- The plumbing codes applicable in the respective countries must be observed
- The outlet temperature during testing was 40°C.

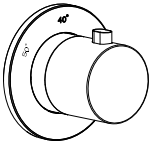

# 120101 (01-06)

Concealed thermostatic valve

## Demension Drawing

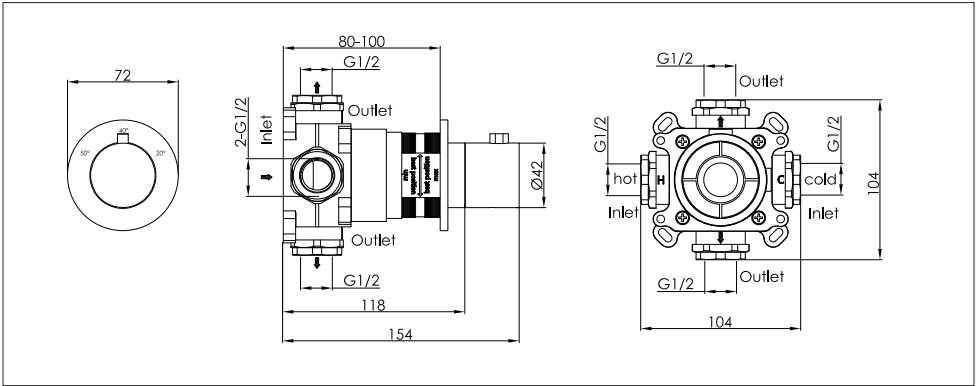

## Explosive Drawing

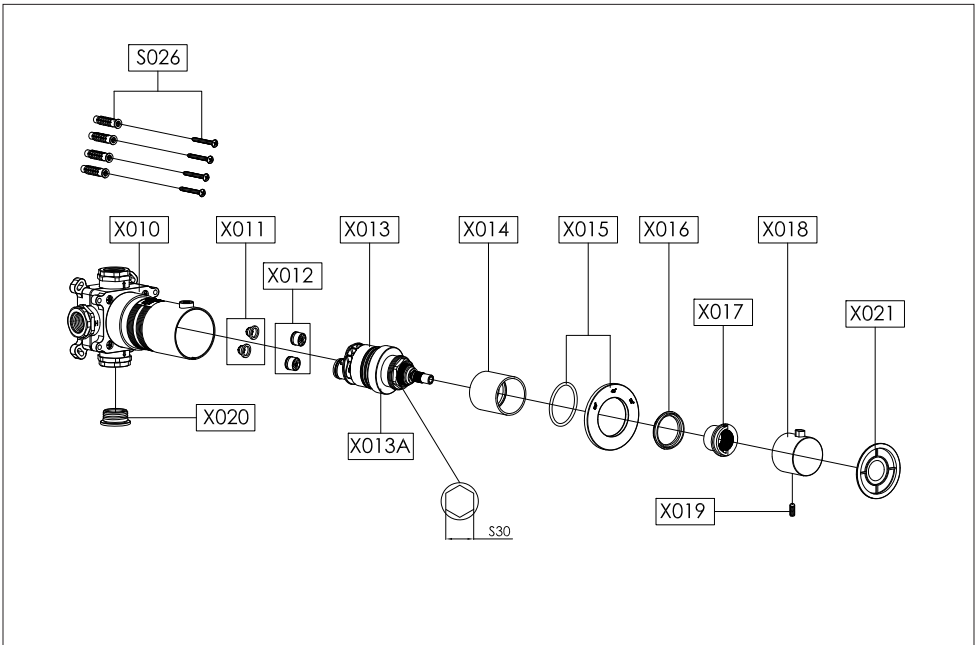

# Installation Steps

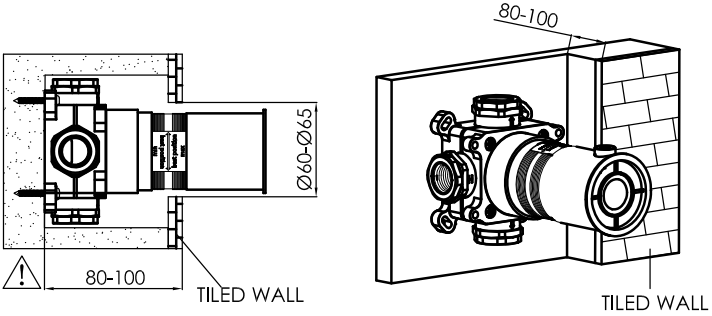
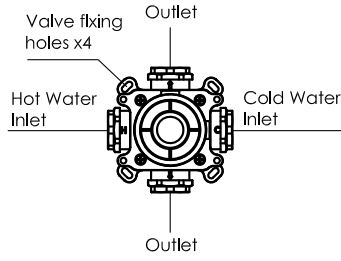

1

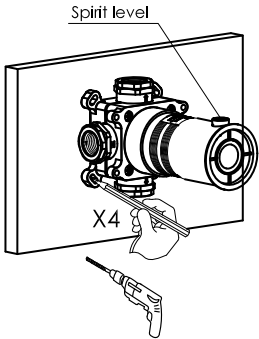

2

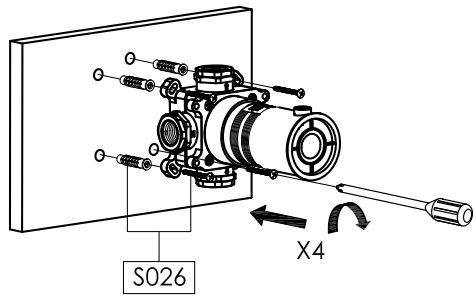

3

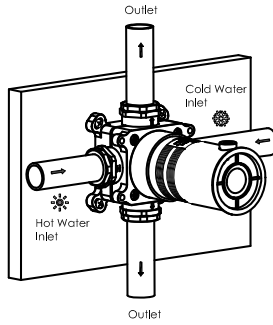

4

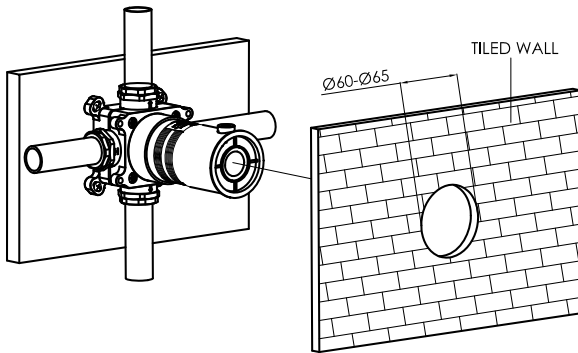

5

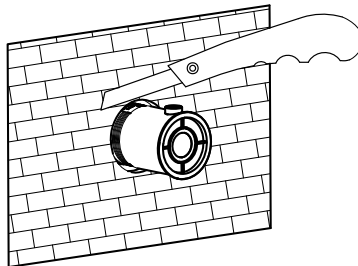

6

Set vertically –or slightly counter clockwise (button alignment)

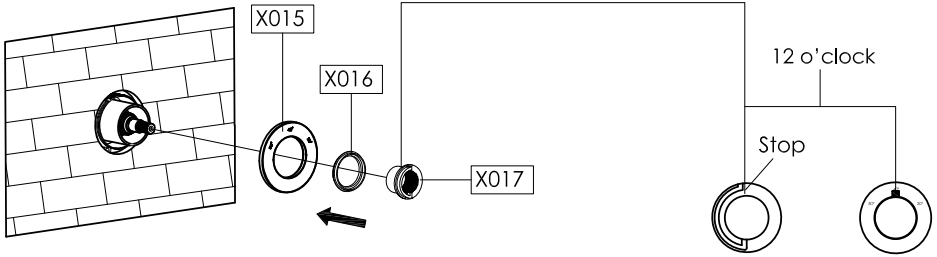

7

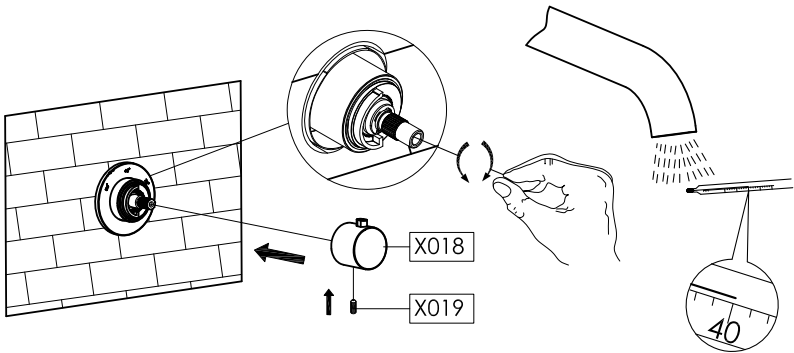

8

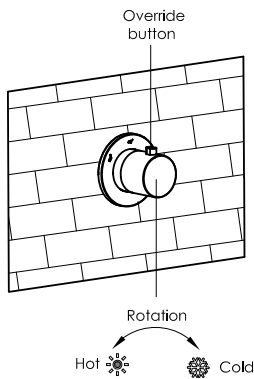

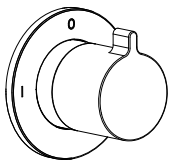

# 120105 (01-06)

Concealed stop valve

## Dimension Drawing

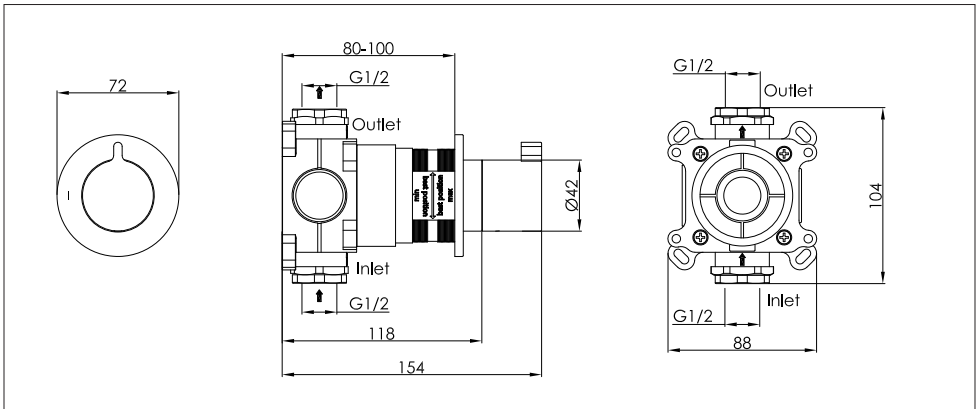

## Explosive Drawing

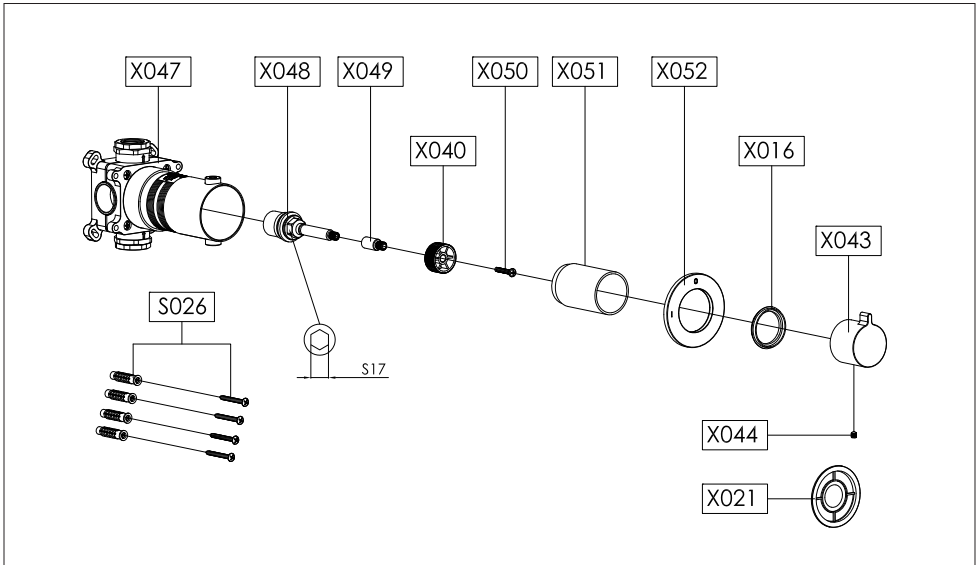

# Installation Steps

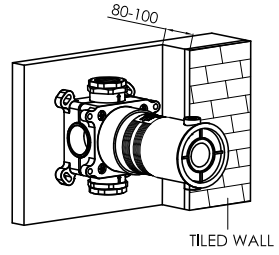
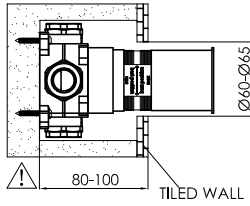
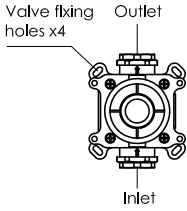

1

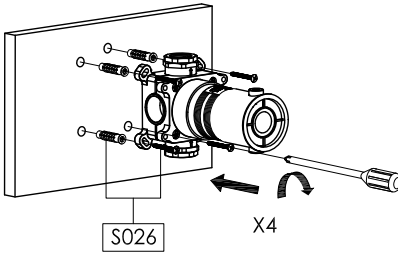

2

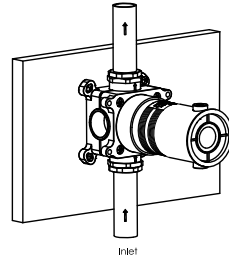

3

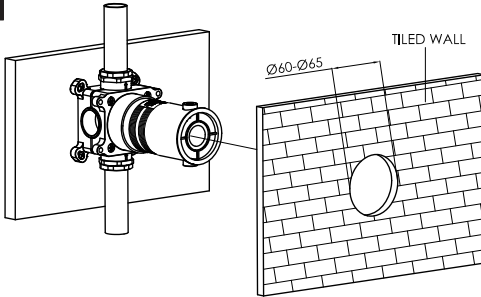

4

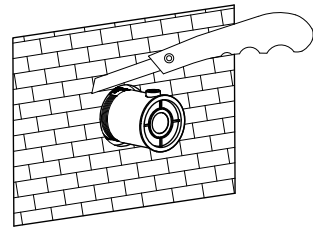

5

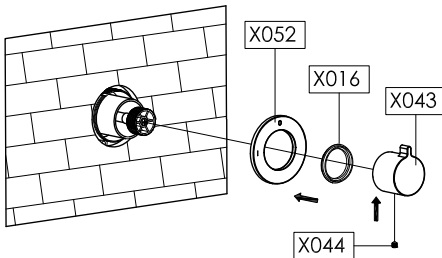

6

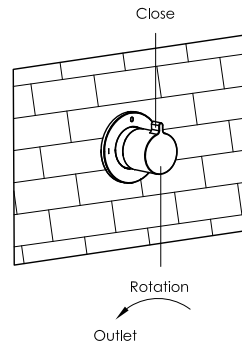

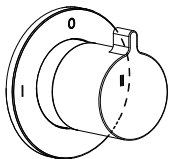

# 120103 (01-06)

2-way concealed diverter (including closing function)

## Dimension Drawing

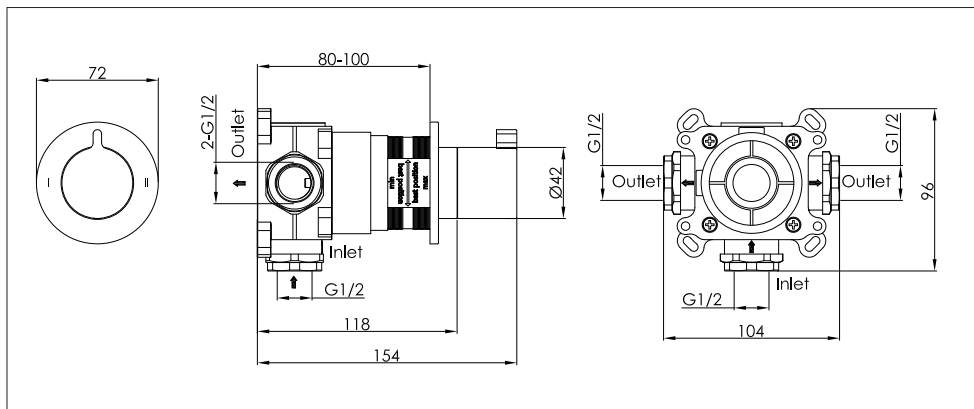

## Explosive Drawing

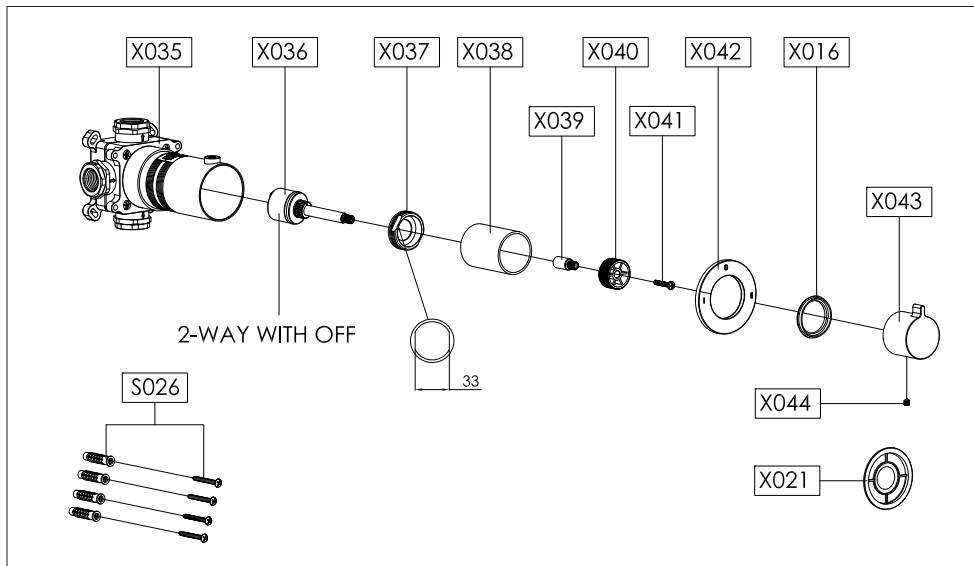

# Installation Steps

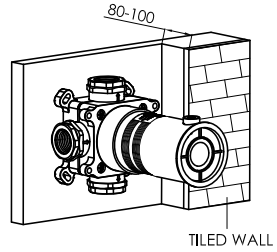
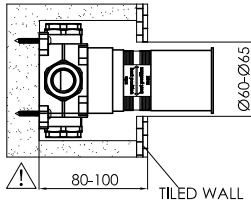
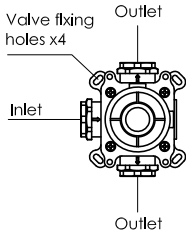

1

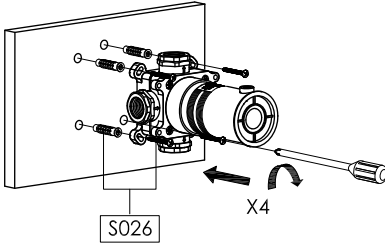

2

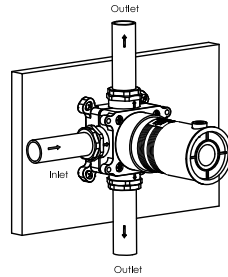

3

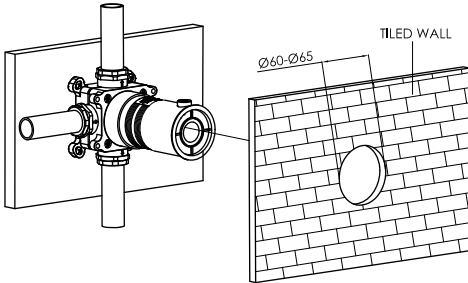

4

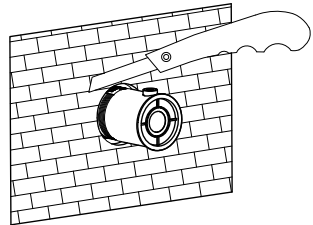

5

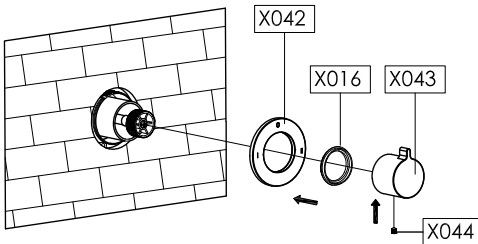

6

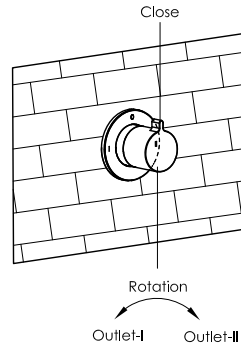

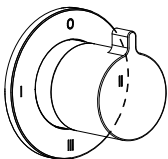

# 120106 (01-06)

3-way concealed diverter (including closing function)

## Dimension Drawing

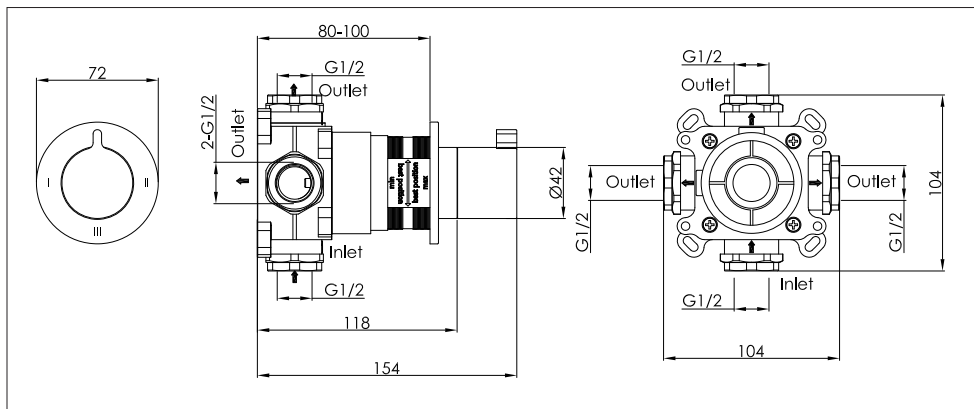

## Explosive Drawing

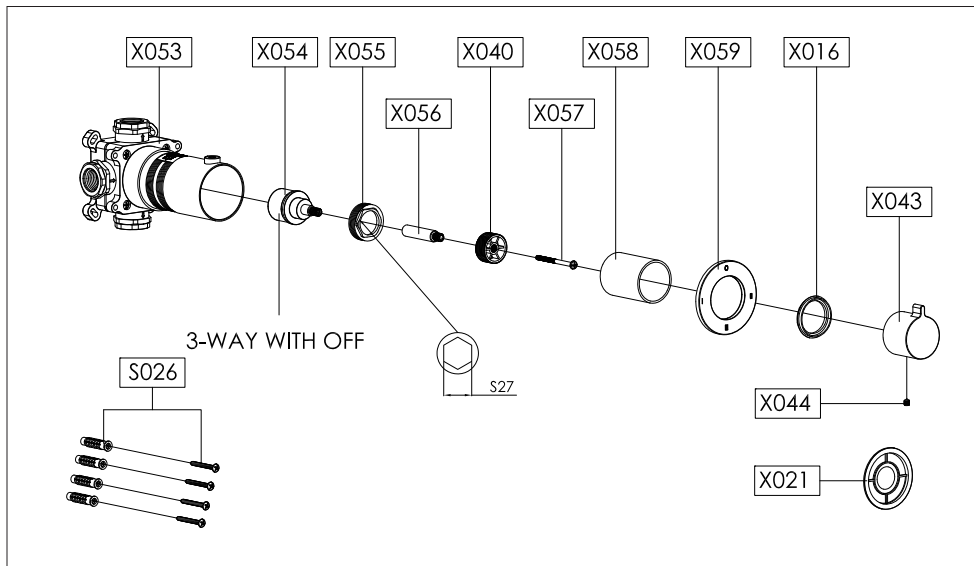

# Installation Steps

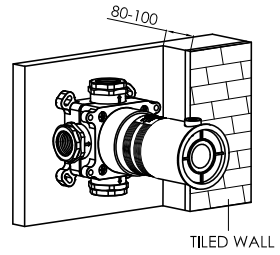
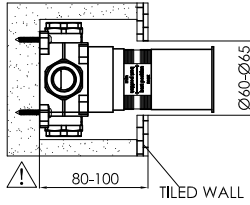
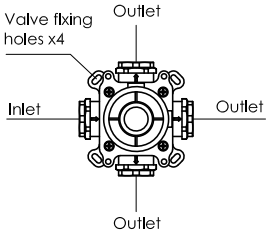

1

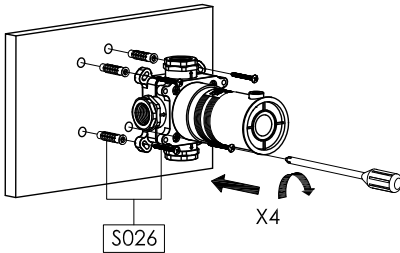

2

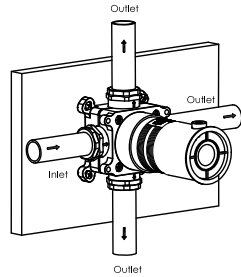

3

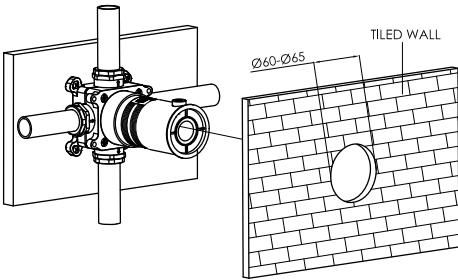

4

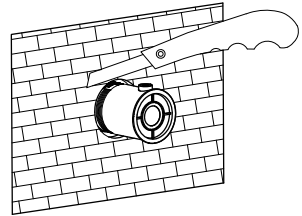

5

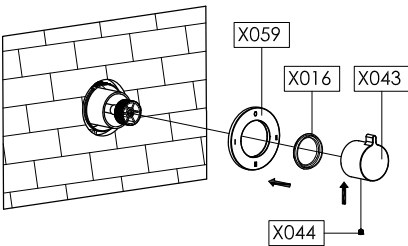

6

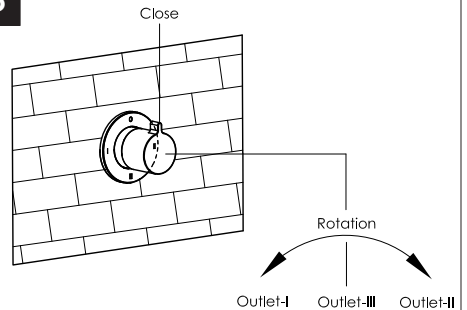

# 120108 (01-06)

Push-button concealed stop valve  
with flow adjustment

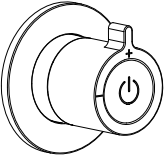

## Dimension Drawing

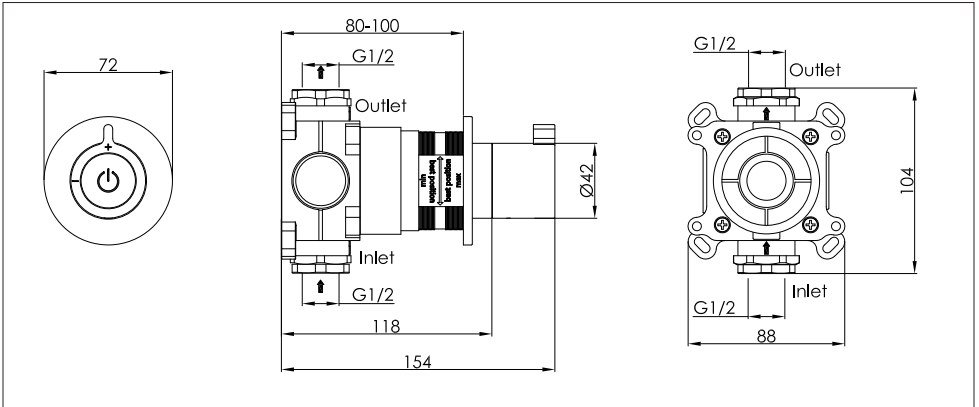

## Explosive Drawing

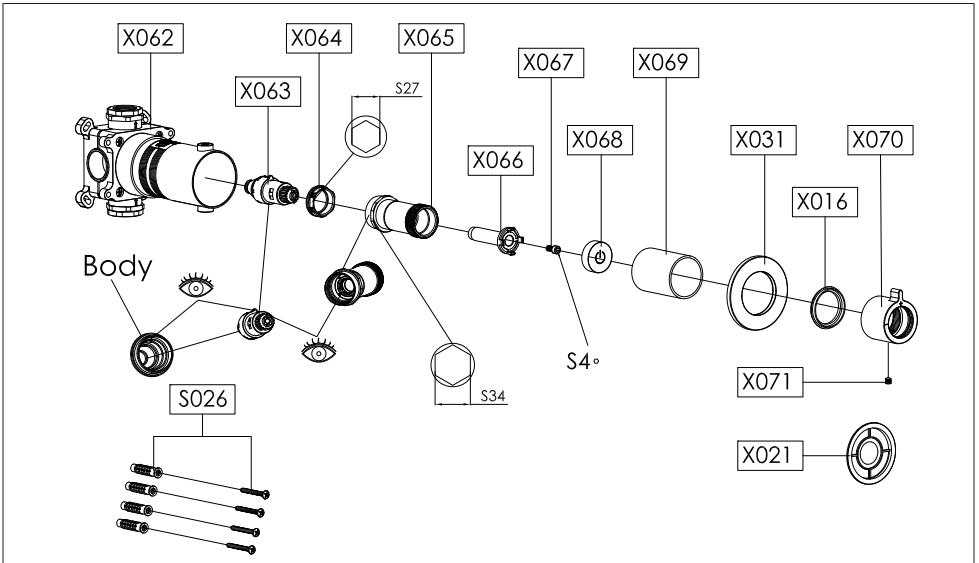

# Installation Steps

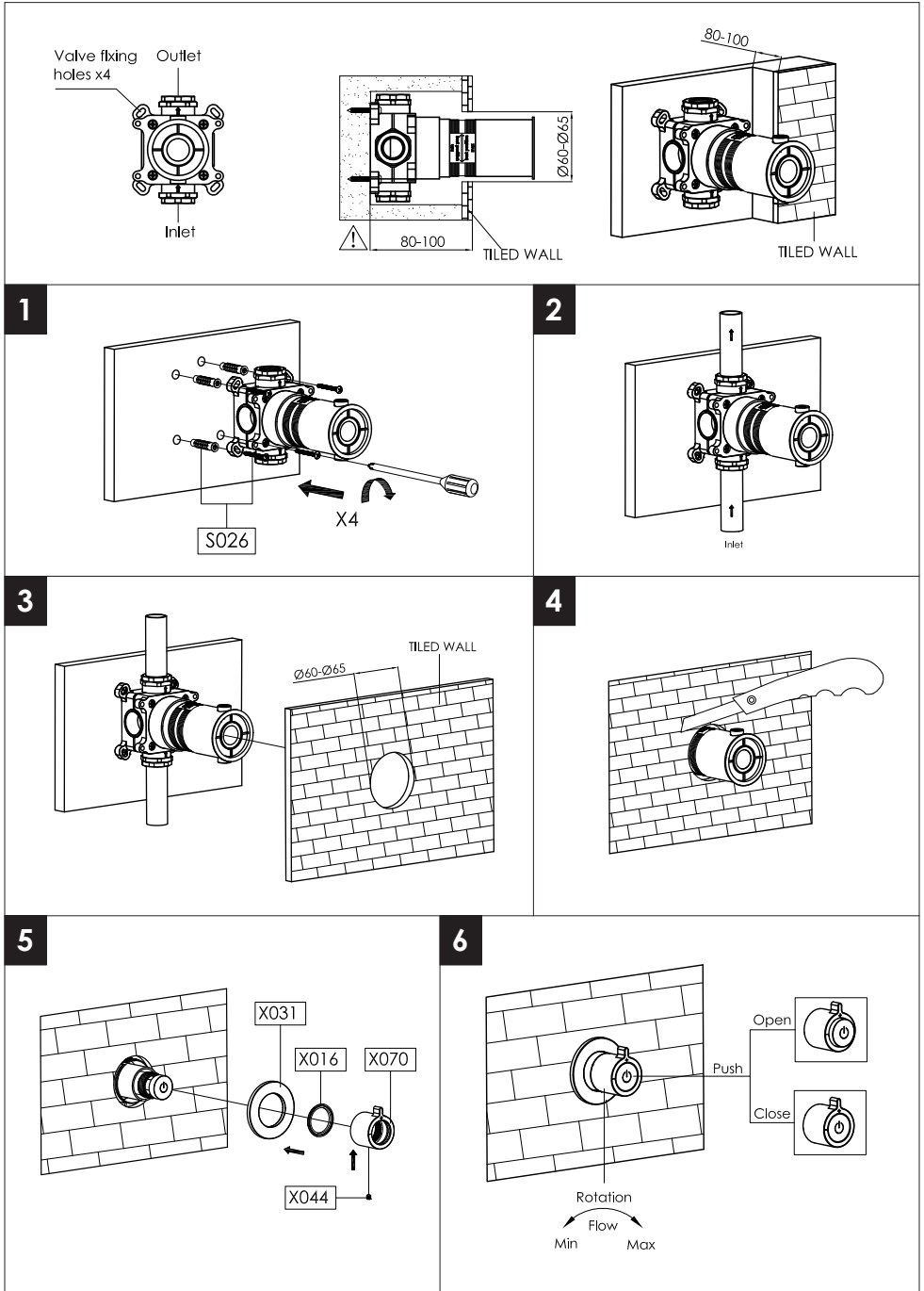

# Vertical mounting instructions (Standard installation)

## -2 and 3 outlet

120101+120103

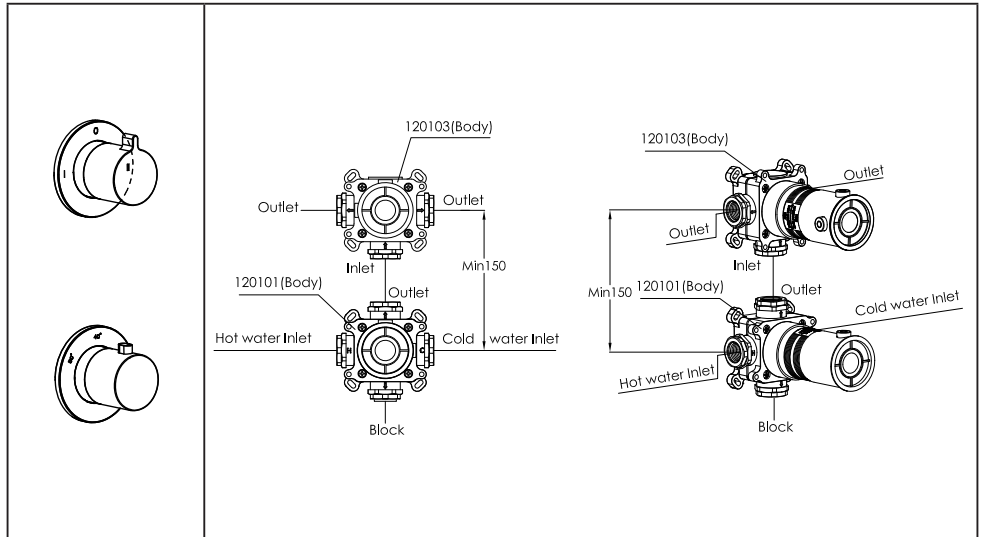

120101+120106

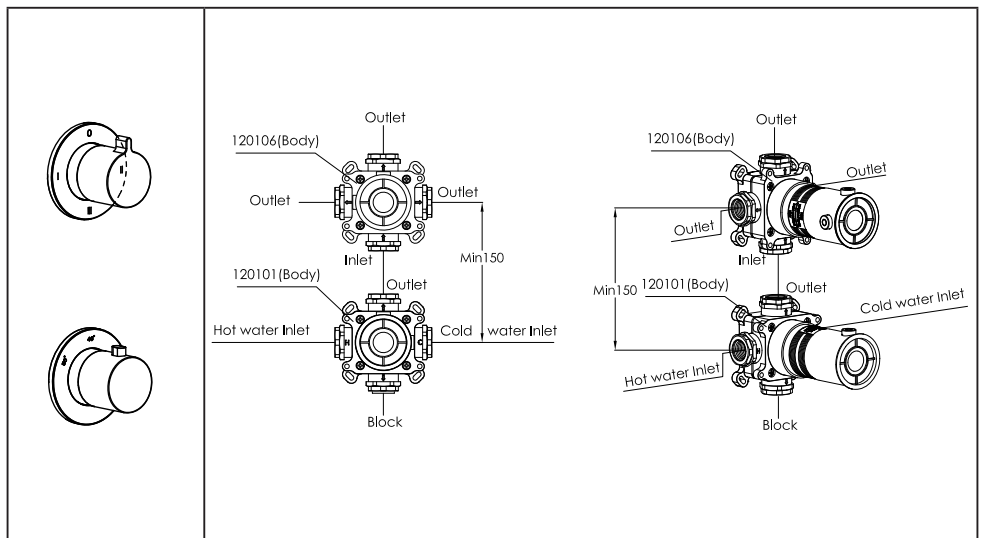

# Vertical mounting instructions (Standard installation)

## -2 and 3 outlet

120101+120105+120105

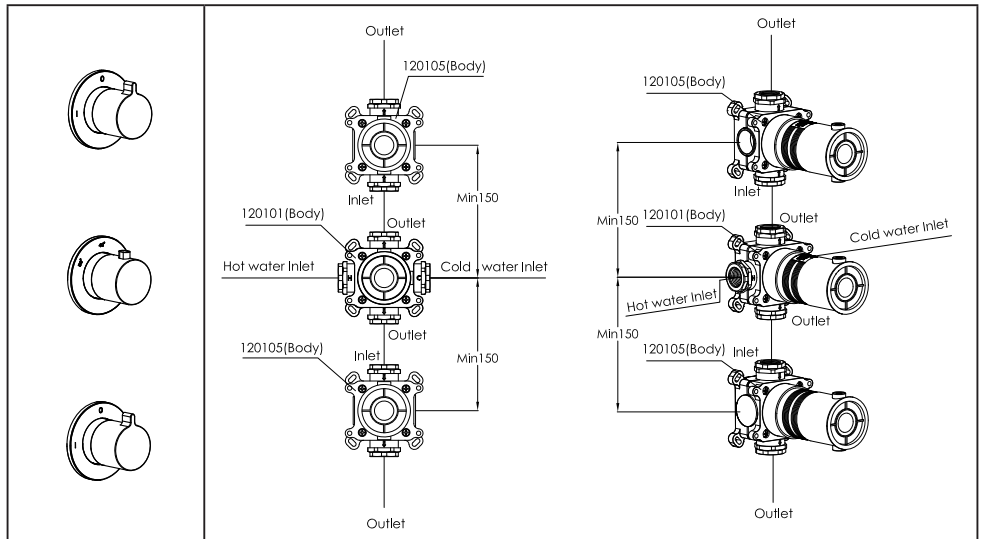

120101+120105+120103

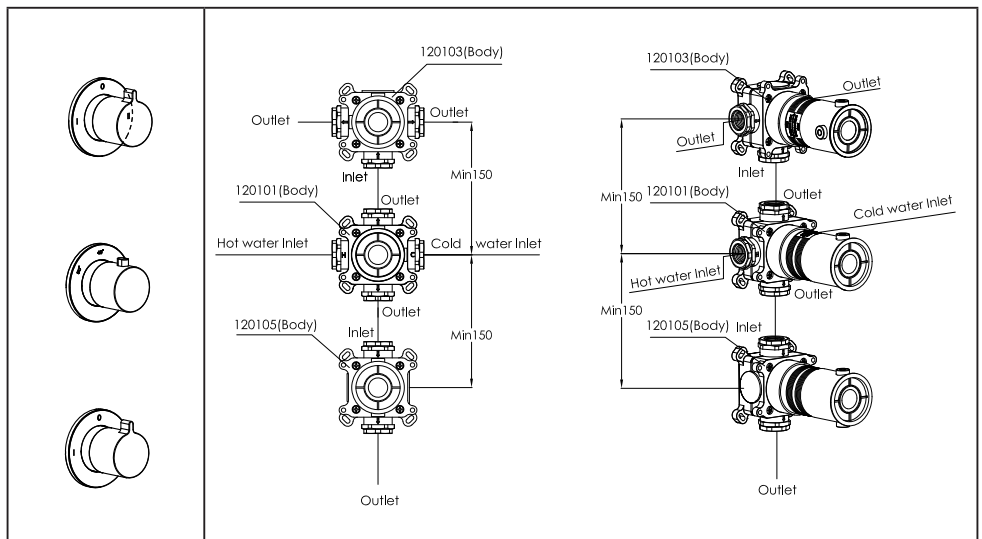

# Horizontal mounting instructions - 2 and 3 outlet

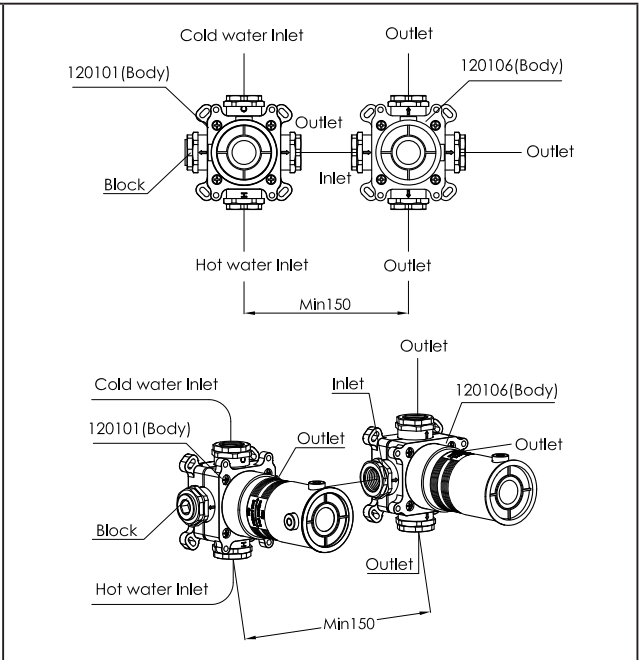
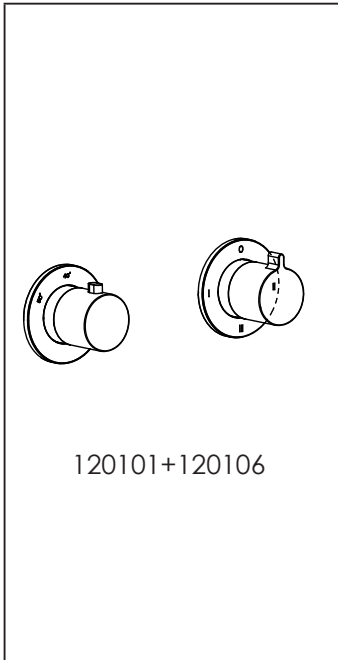
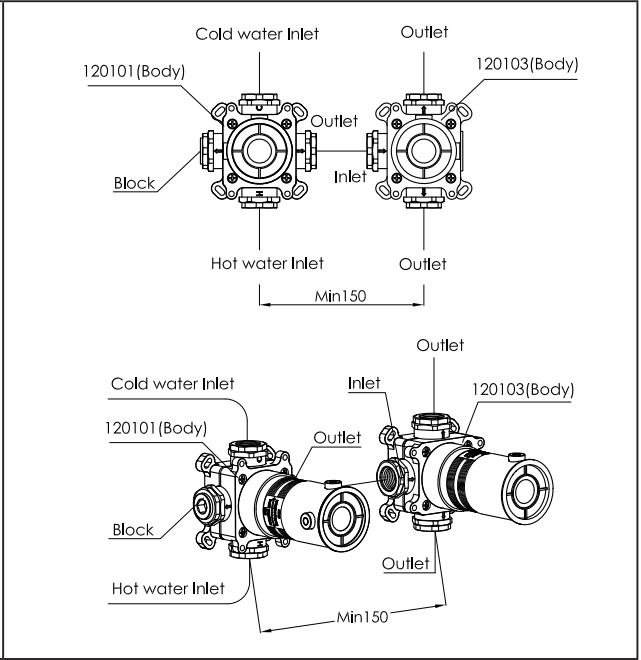
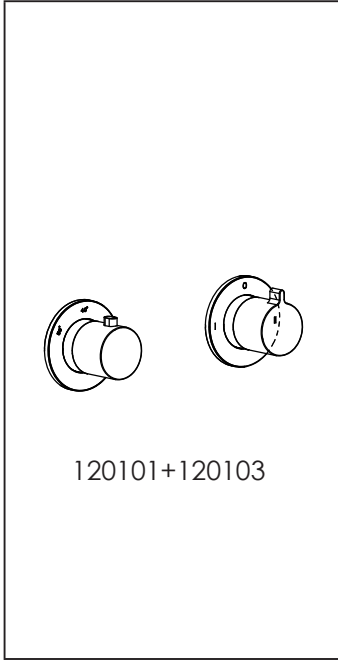

# Horizontal mounting instructions - 2 and 3 outlet

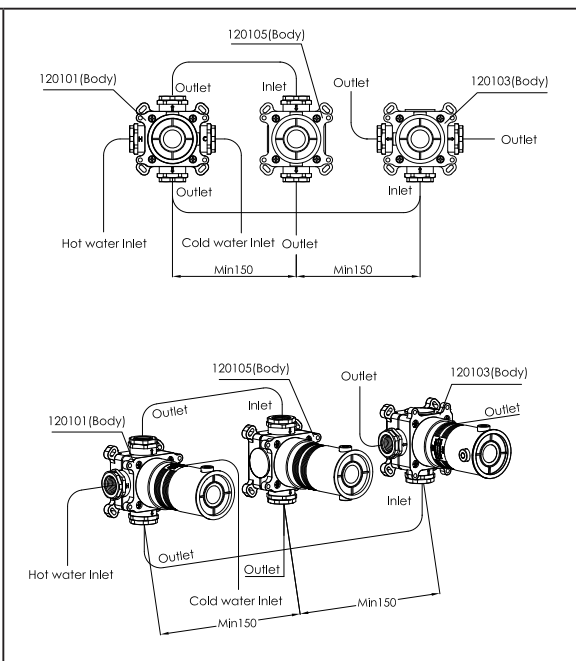
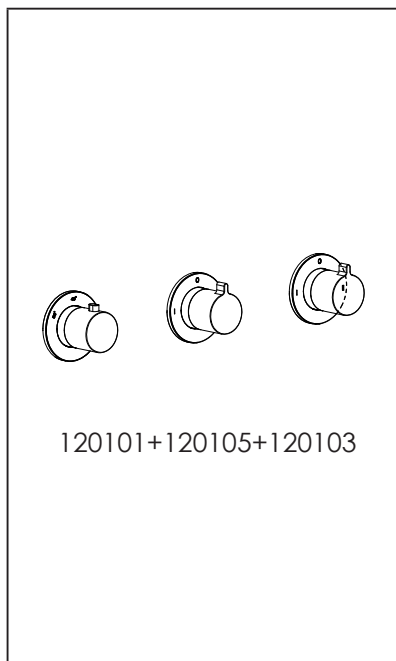
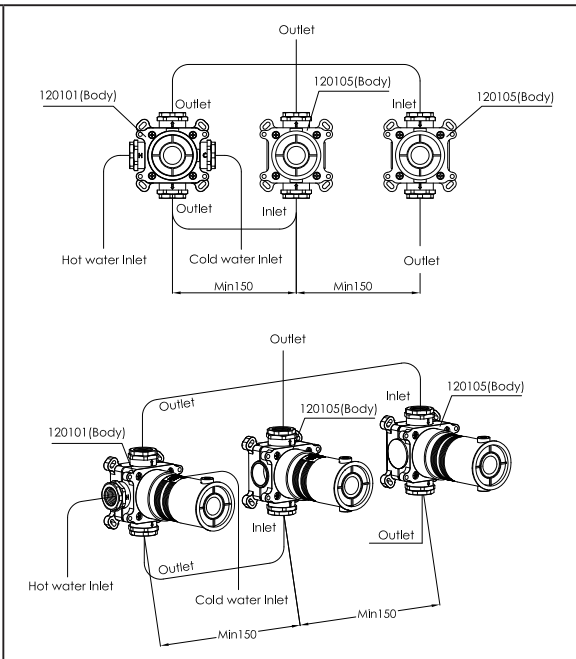
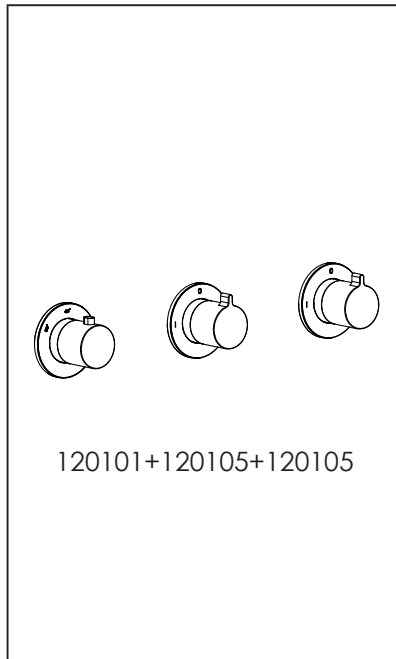

# Vertical mounting instructions (Standard installation)

## -2 outlet

120101+120108+120108

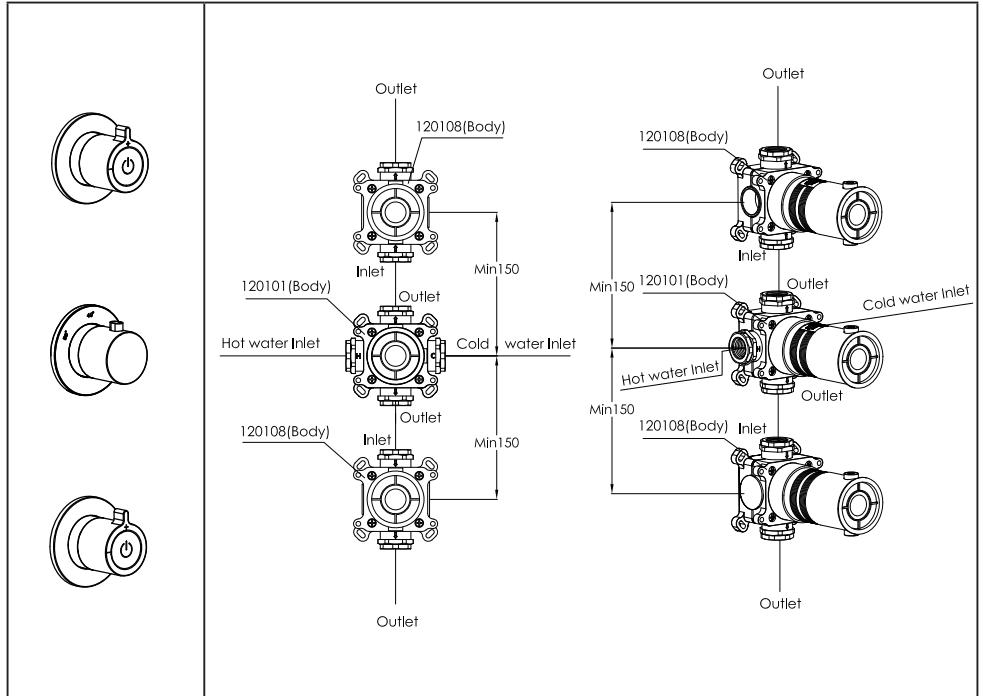

# Horizontal mounting instructions

## -2 outlet

120101+120108+120108

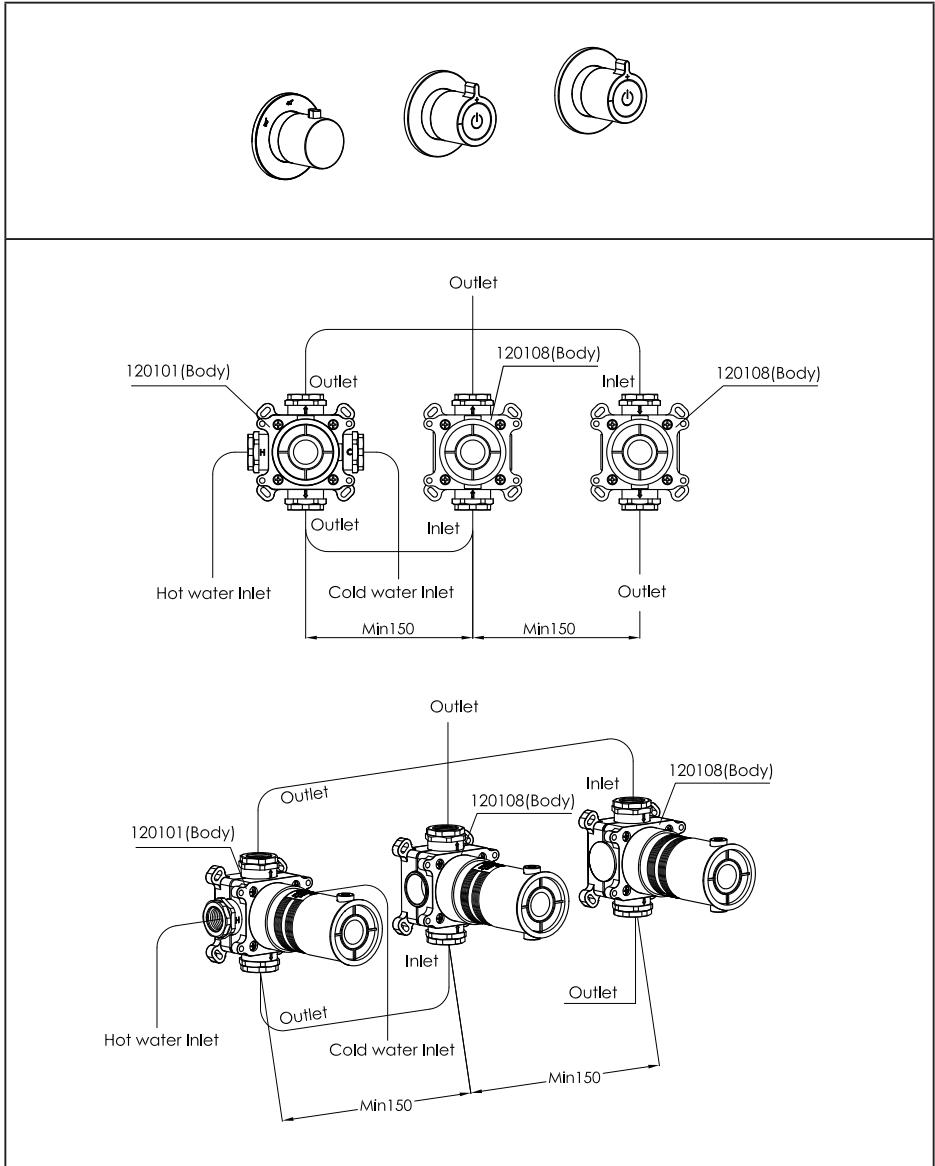

# SERVICING THE THERMOSTATIC CARTRIDGE

If after a period of time you experience temperature problems with your shower valve, particularly if you are in a hard water area, it is quite common for limescale deposits to have formed in the thermostatic cartridge. We recommend you remove the cartridge and soak it in a descaling fluid which normally resolves the problem. It is difficult to set a regular servicing time scale as it is subject to water conditions and usage.

To clean the filters, you must first remove the cartridge from the housing.

## Removing the Cartridge

1. Shut off the water supply to both inlets at the isolating valves.
2. Remove the handle, cover plate ring, cover plate to gain access to back of valve.
3. Remove the thermostatic cartridge by unscrewing with a spanner.

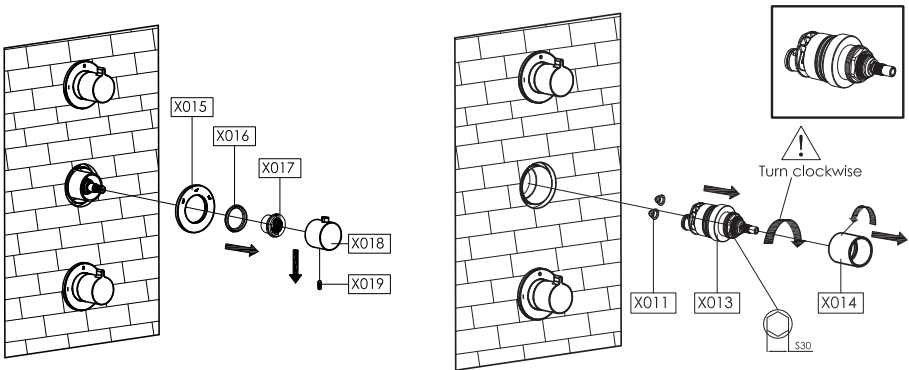

4. Clean the filters by rinsing them in water to remove the dirt and soaking them in vinegar or descaling agent.

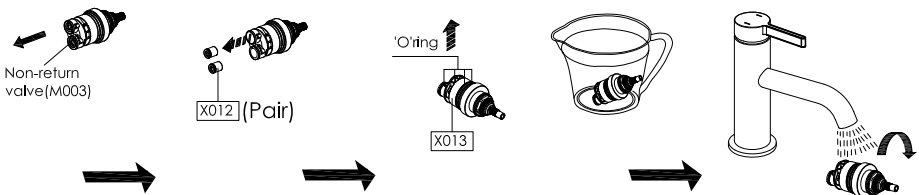

5. Before reassembling the cartridge, clean its housing with a wet cloth and grease the 'O' rings using a suitable silicone lubricant. Reassemble the cartridge.
6. Place cartridge back into valve and tighten the nut with a spanner.
7. Place the plastic stop ring so that the stop is at the 12 o'clock position.
8. Make sure everything is tight and secure, turn on the water supply at the isolating valves.

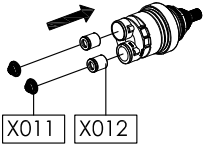

Horizontal Installation	Vertical Installation

**SETTING 'SAFE TEMPERATURE**

Set vertically -or- slightly counter clockwise (button alignment)

12 o'clock

Stop

Stop ring X017

# Cartridge replacement

## 120105 (01-06)

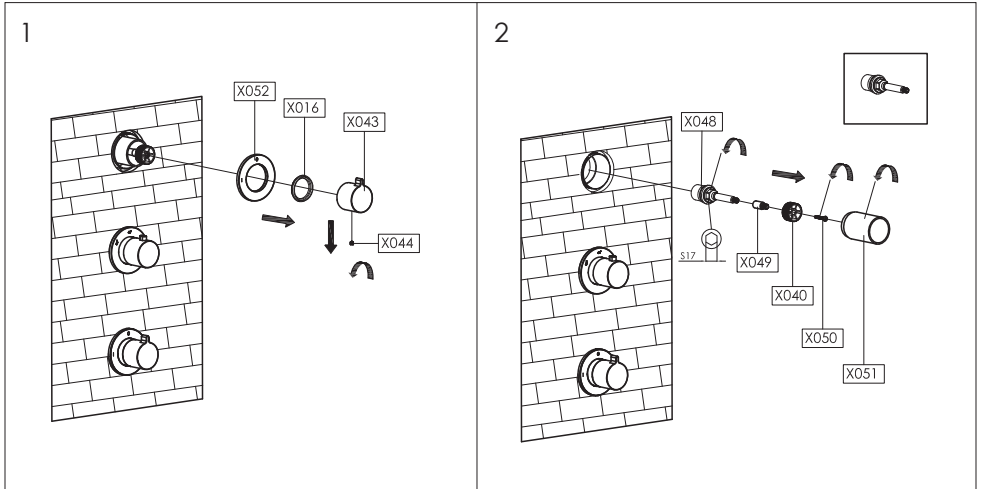

## 120108 (01-06)

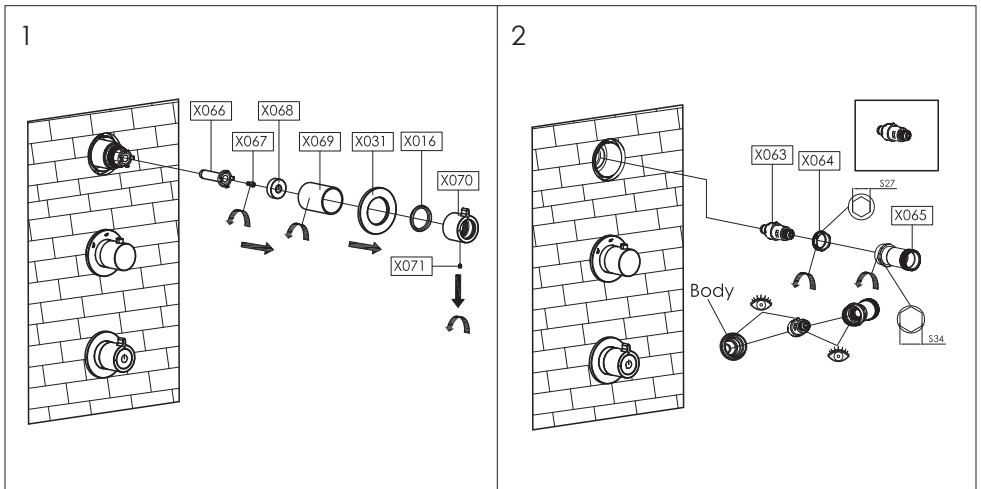

# Cartridge replacement

## 120103 (01-06)

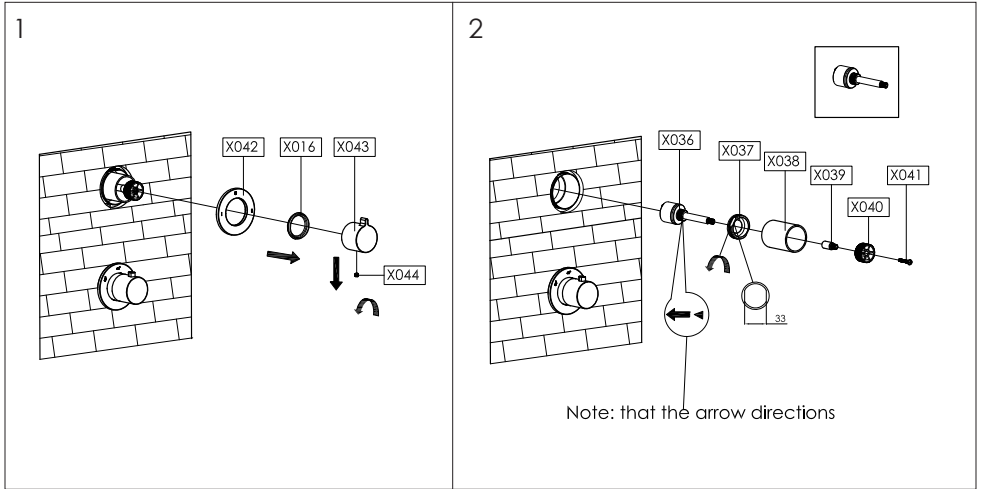

## 120106 (01-06)

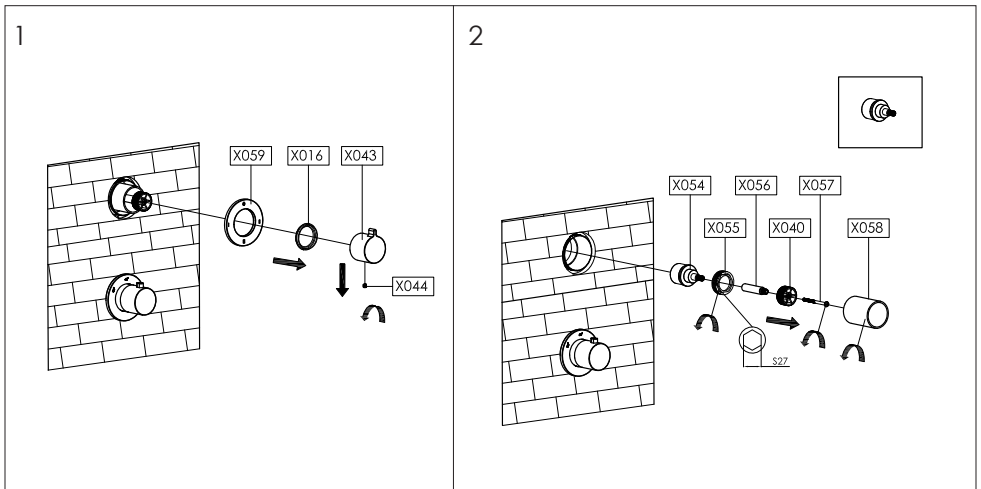

# Cartridge replacement (Horizontal installation)

## 120103 (01-06)

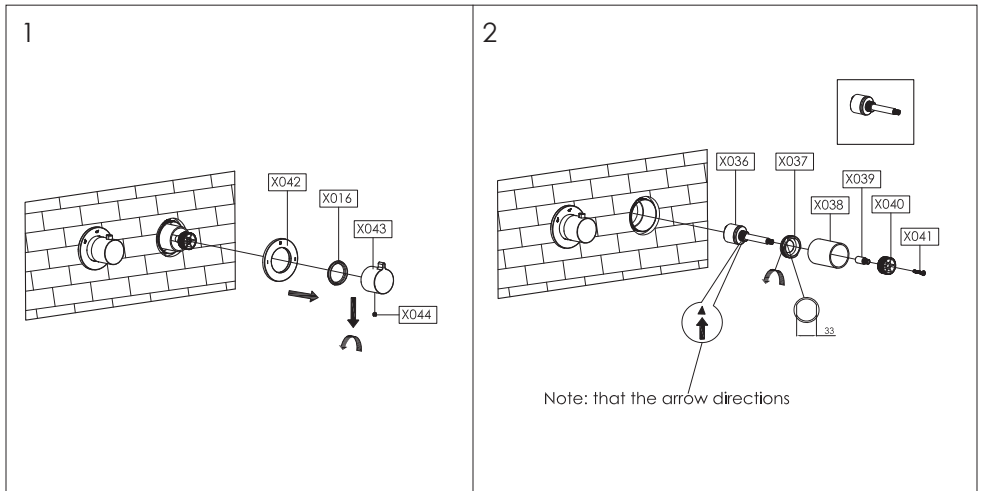

## 120106 (01-06)

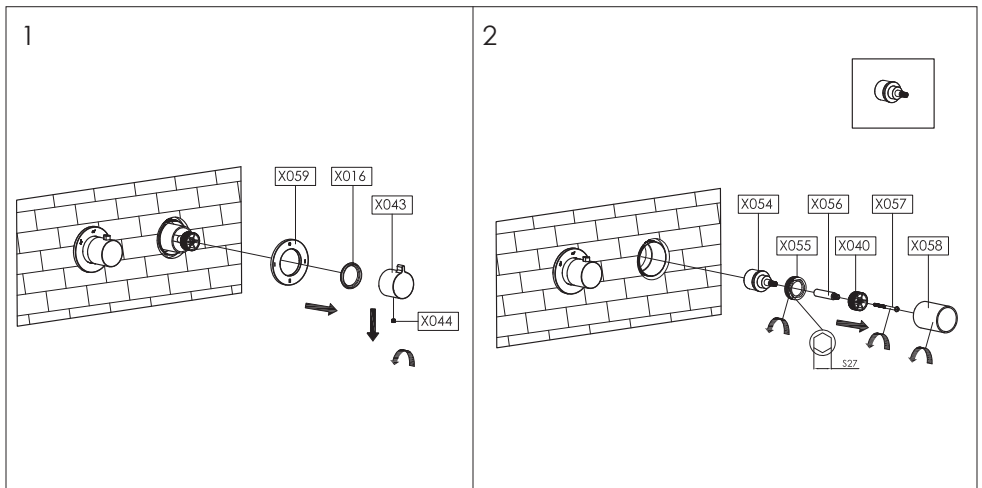

# MAINTENANCE

## CARE OF THE MIXER

Our products are finished to the highest standard and due care needs to be taken to ensure their looks are retained.

We recommend cleaning all products with a soft damp cloth **ONLY** and advise strongly against the use of **ALL** cleaning products i.e. powders and liquids.

If the above instructions are not followed this will invalidate your guarantee in the event of a problem occurring.

